



**CATEYE**  
**SYNC™**

**CatEyeSYNC™**

**Manual**

Information in the instruction manual is subject to change without notice.

CatEyeSYNC-191011 3

**Introduction**



---

**Pairing with a Light**



---

**Operating the Light**



---

**Operation and  
Changing Settings  
with CatEyeSYNC™**



---

**Firmware Update**



---

**Frequently Asked  
Questions**



# Introduction

CatEyeSYNC™ is an app that enables synchronization of multiple lights when used with paired CatEyeSYNC™-compatible lights. The on/off and mode change operations of paired lights can be synchronized regardless of whether CatEyeSYNC™ is open, while the app can be used to configure light settings, check remaining battery levels, and receive notifications.

## Before Use

A smartphone and CatEyeSYNC™-compatible light are required to use CatEyeSYNC™.



Smartphone

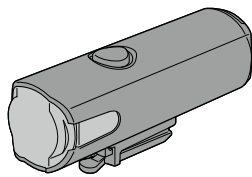

SYNCCore™

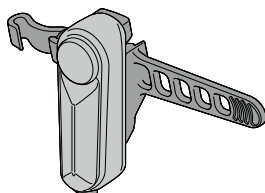

SYNCKinetic™

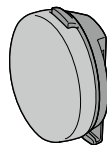

SYNCWearable™

- \* For the latest information on compatible smartphones, see [“CatEyeSYNC™ Compatible Devices”](#).
- \* CatEyeSYNC™ can be used to pair up to 7 lights.

# Pairing with a Light

Pairing with CatEyeSYNC™ is required to synchronize the lights.



## 1. Install CatEyeSYNC™ on your smartphone.

For iPhone

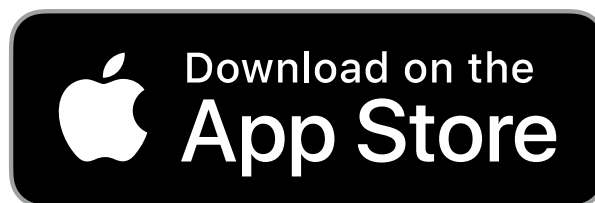

For Android smartphone



- \* Downloading and using the app incurs communication fees. A Wi-Fi connection is recommended.

## 2. Open CatEyeSYNC™ and begin pairing.

- \* Make sure the Bluetooth® function of the smartphone is turned on.

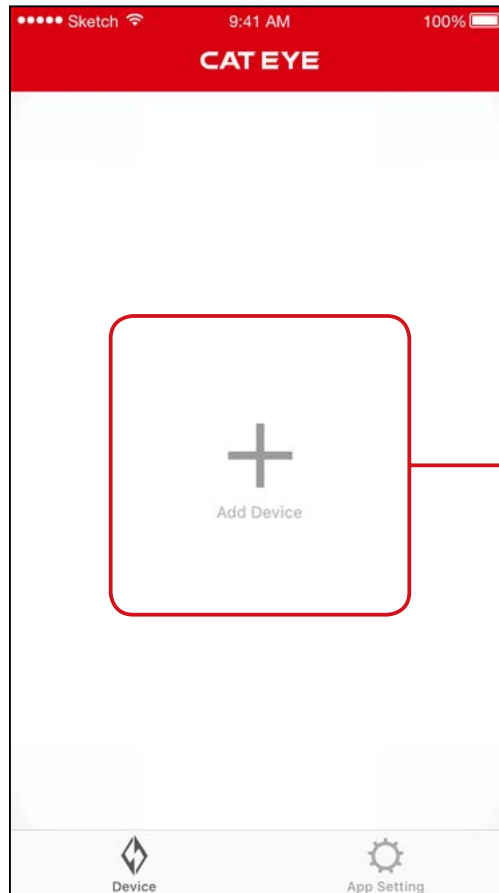

Tap the screen.

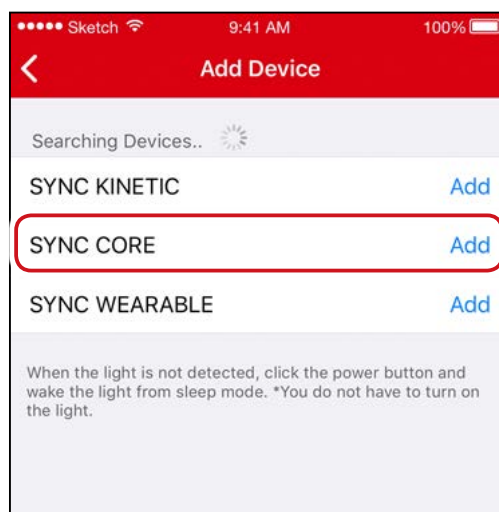
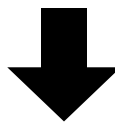

Tap on a detected light.

- \* If no light is detected, click the switch on the light to be paired once.

There is no need to turn the light on.

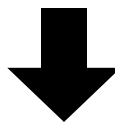
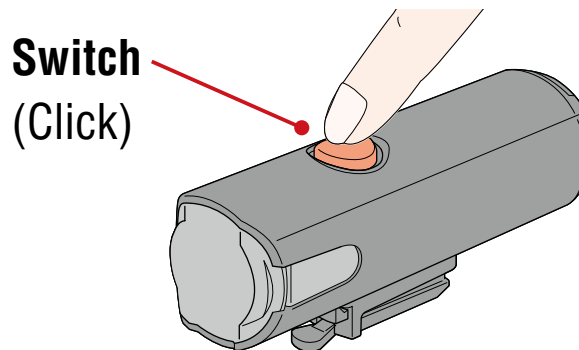

The light will flash, and a message will be displayed on the screen.

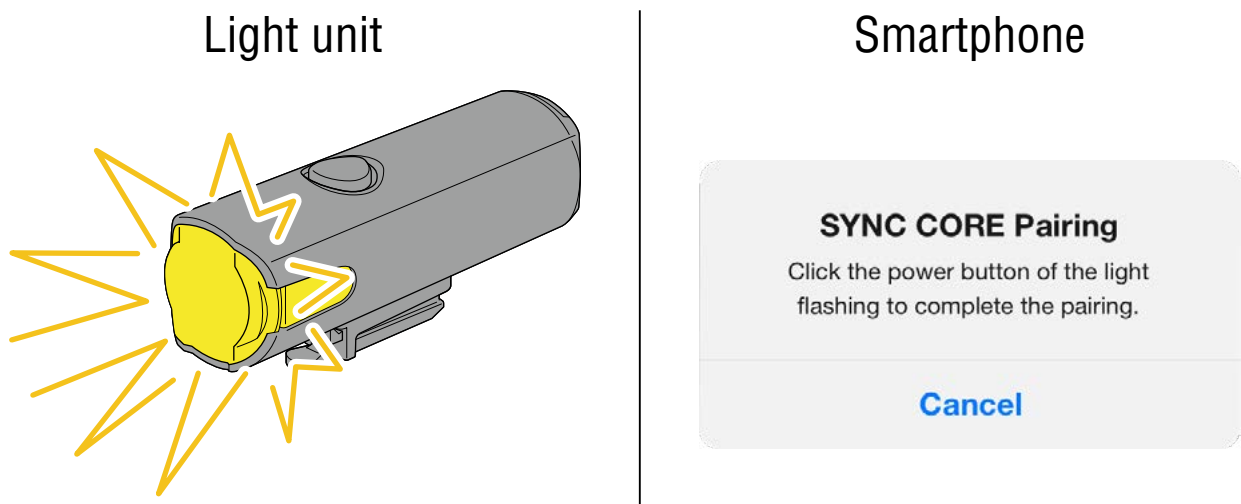

- \* If the light does not flash, tap [Cancel], check the name of the light on the screen, and then tap [Add].

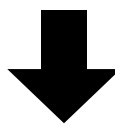

Click the switch on the flashing light.

The light will turn on and pairing will be complete.

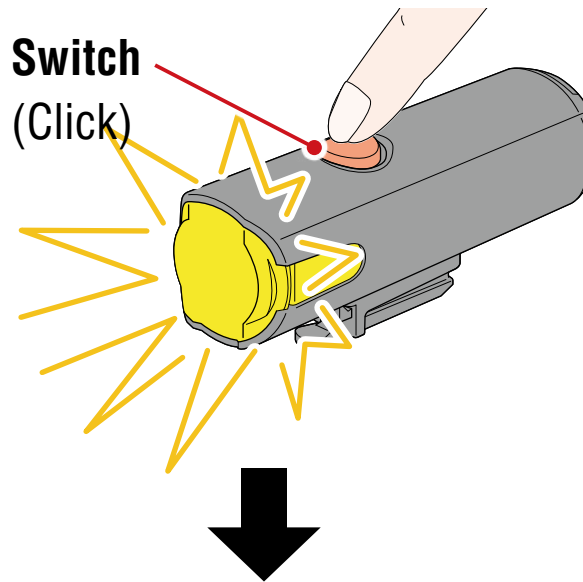

When paired with a headlight, the following message will be displayed.

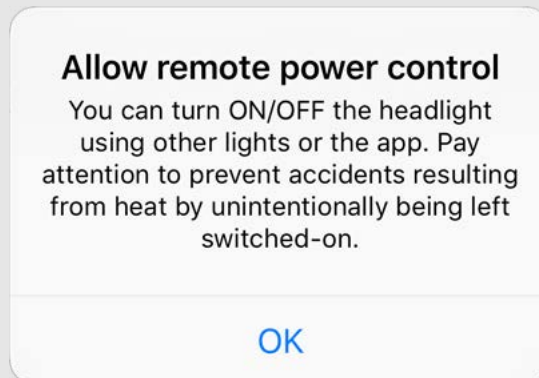

Tap [OK].

Repeat the process to pair with other lights.

# Operating the Light

Operation of the switch on a paired light or of CatEyeSYNC™ will be carried out as follows.

## **⚠ Caution!**

**Synchronization may be affected by the communication environment or the usage situation.**

\* The CatEyeSYNC™ default status is used here as an example.

## **On/Off Operation (Press and hold the switch)**

Switch operation of any light turn all lights on/off.

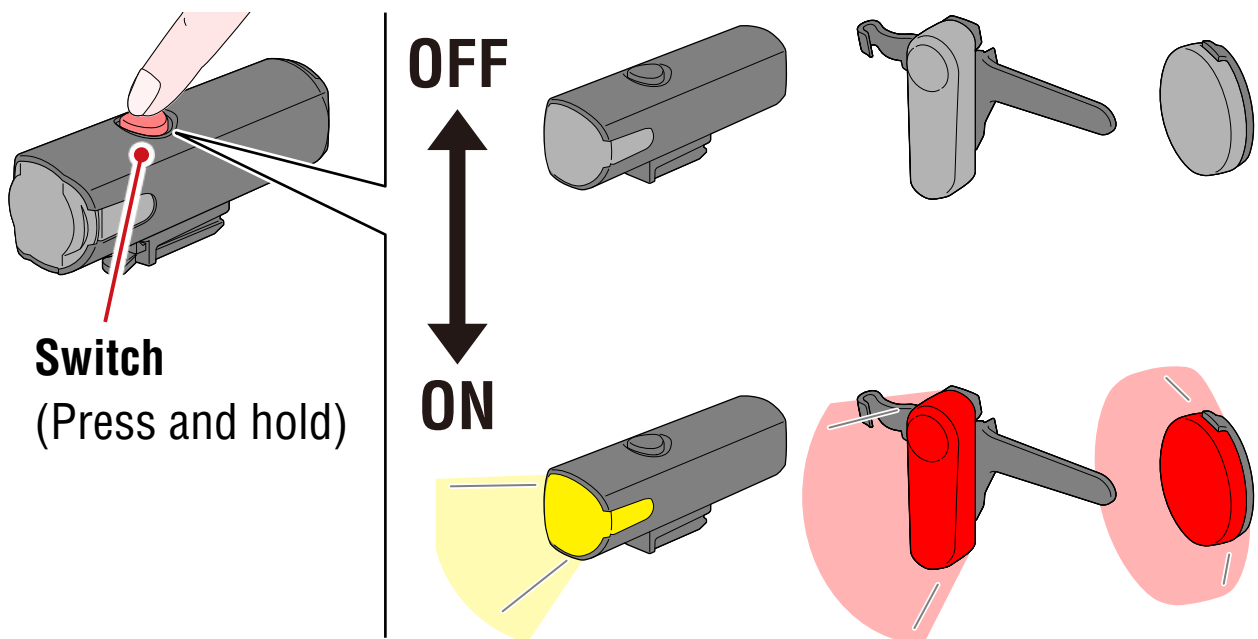

## **Mode Change (Press the switch)**

### ● Headlight

Mode change will not be synchronized with other lights.

## ● Taillight, Safety Light

Mode change will be synchronized with all taillights and safety lights.

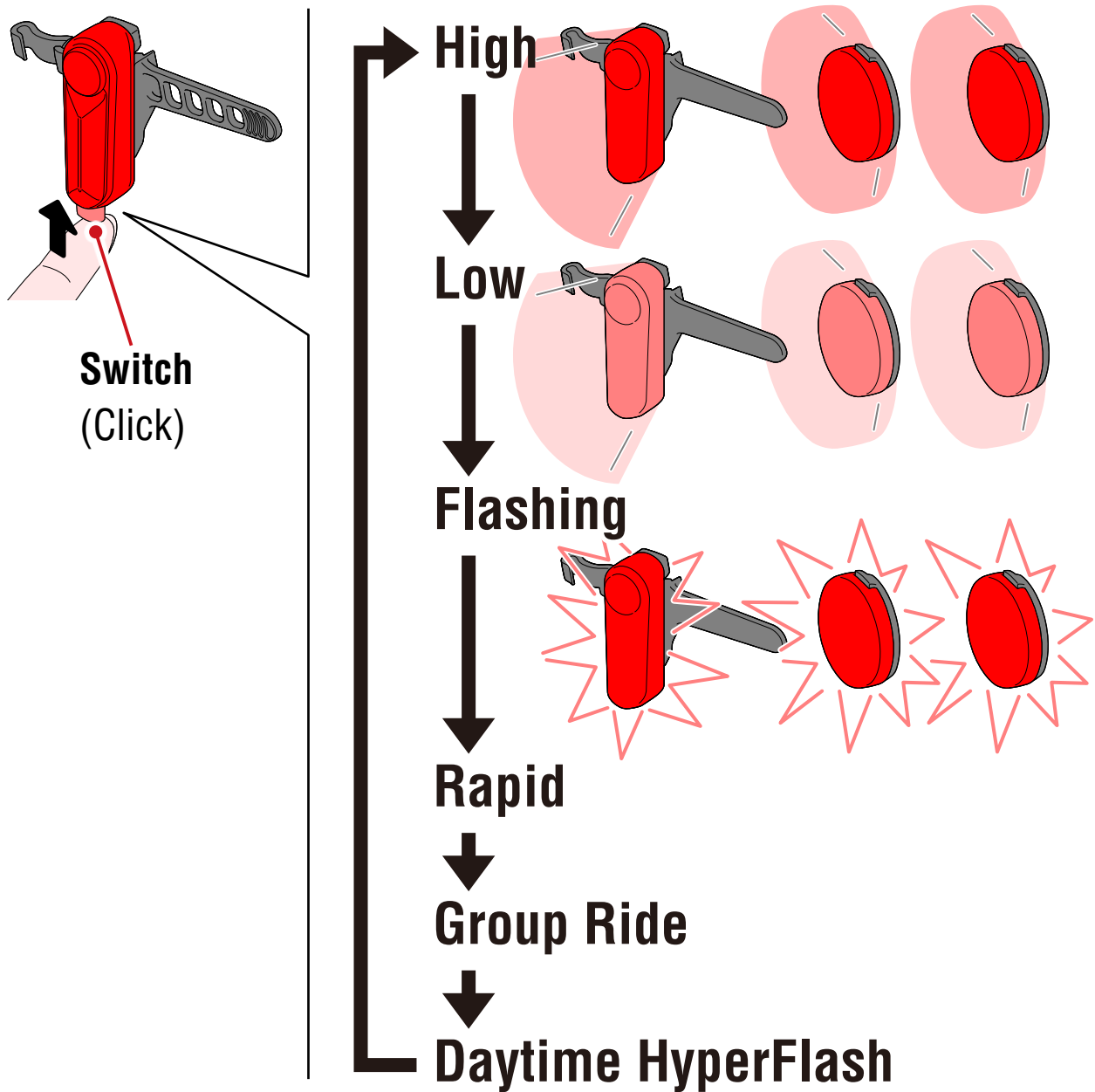

## Kinetic Operation

**Important : Connection of a light with kinetic function is required.**

When a light with kinetic function senses deceleration, all paired taillights and safety lights will illuminate brighter for 2.5 seconds in kinetic mode.



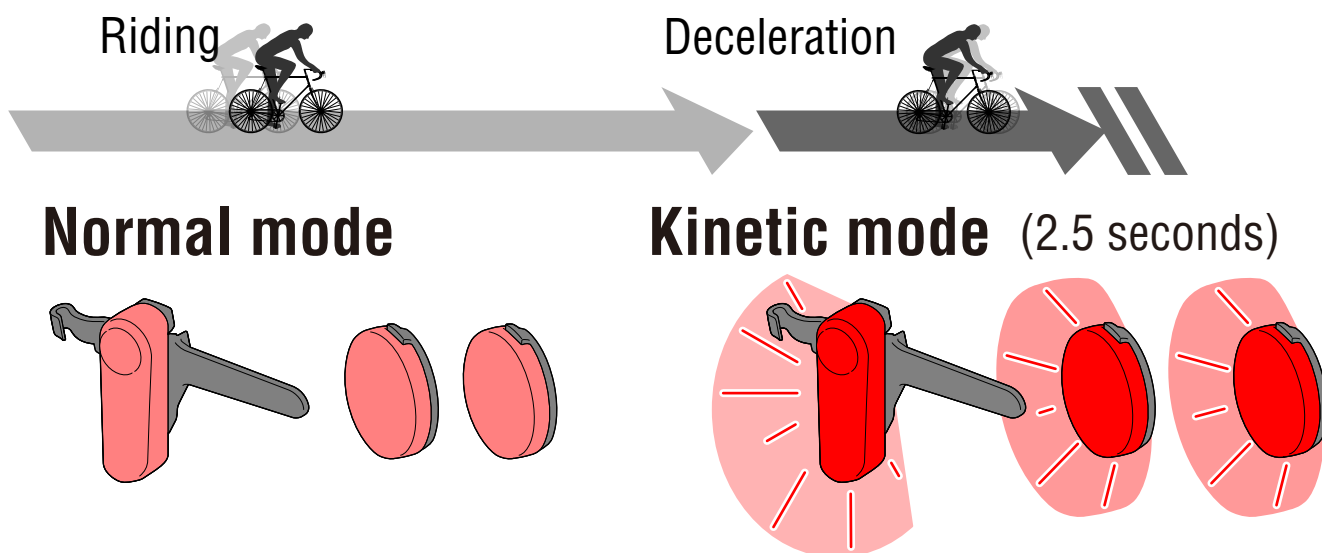

## Standby and Sleep



CatEyeSYNC™-compatible lights have a standby state that allows connection to be maintained, and a sleep state running power-saving function.

State	Description
Standby	<ul style="list-style-type: none"> <li>● <b>Connection can be established immediately when CatEyeSYNC™ is activated, and operation is possible from the app.</b></li> <li>● <b>Can synchronize with other paired lights even when CatEyeSYNC™ is not open.</b></li> </ul> <p>* After use, if the light is not used again within about 4 days, the light will enter the sleep state.</p>

<b>Sleep</b>	<ul style="list-style-type: none"> <li>● <b>No connection can be established even when CatEyeSYNC™ is activated.</b></li> <li>● <b>Cannot synchronize with other paired lights.</b></li> </ul> <p>* Click the switch on the light. The light's LED will flash three times, indicating that the light is in the standby state.</p>
--------------	---

## Light Connection Status

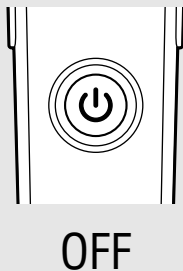
The indicator on a paired headlight can be used to check the connection status and remaining battery levels of other lights.

Indicator	State
 <p>OFF</p>	Other lights are disconnected.
 <p>Steady (green)</p>	At least one other light is currently connected.
 <p>Flashing (green)</p>	Other lights are low in battery.

# Operation and Changing Settings with CatEyeSYNC™

Tap the desired light from the CatEyeSYNC™ home screen (device list).

\* To change the settings, the light must be connected with CatEyeSYNC™.

## Home screen (Device list)

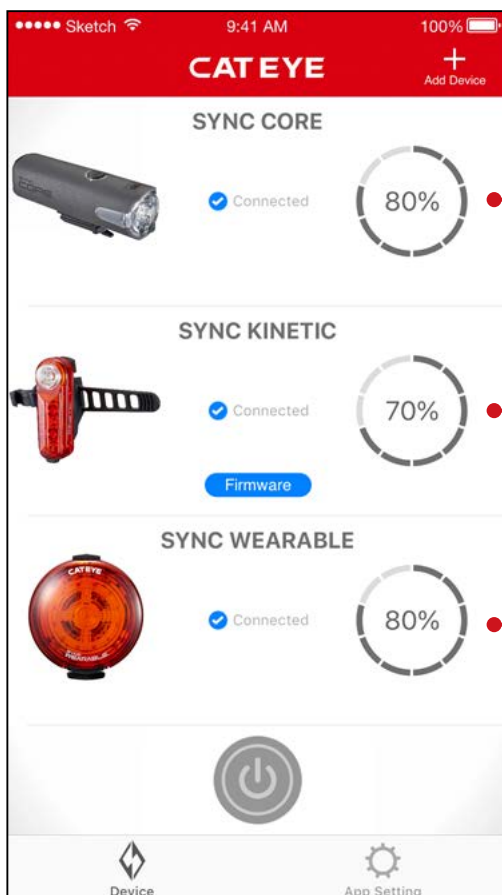

**Tap to go to the headlight device screen**

**Tap to go to the taillight device screen**

**Tap to go to the safety light device screen**

# Headlight

## Device screen

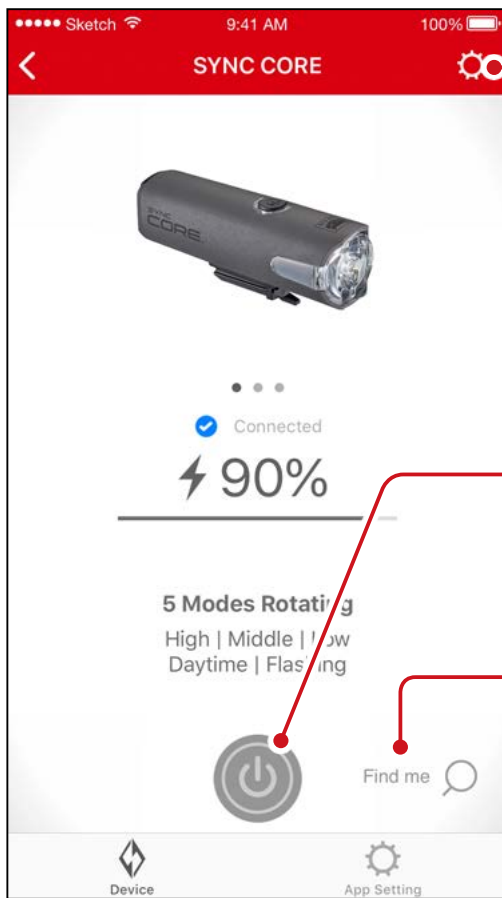

**Tap to go to the setting screen**

### Switch

Press and hold to turn the light on/off.

### Find me (\*) / Mode

\* The selected light will flash for several seconds.

## Setting screen

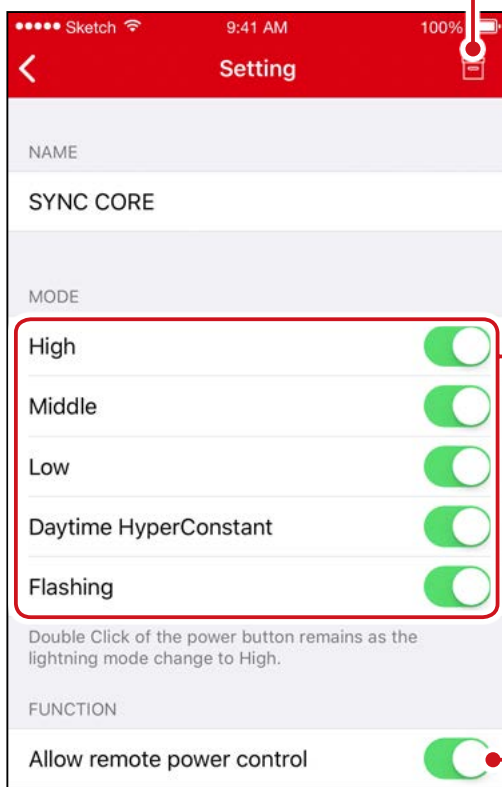

### Unpair icon

Unpairs the light.

\* Unpairing can also be performed by pressing and holding the switch on the light for 10 seconds.

### Mode selection

Modes that have been turned off will be removed.

### Allow remote power control

Turn on/off synchronization with CatEyeSYNC™ or other lights.

# Taillight, Safety Light

## Device screen (Shared)

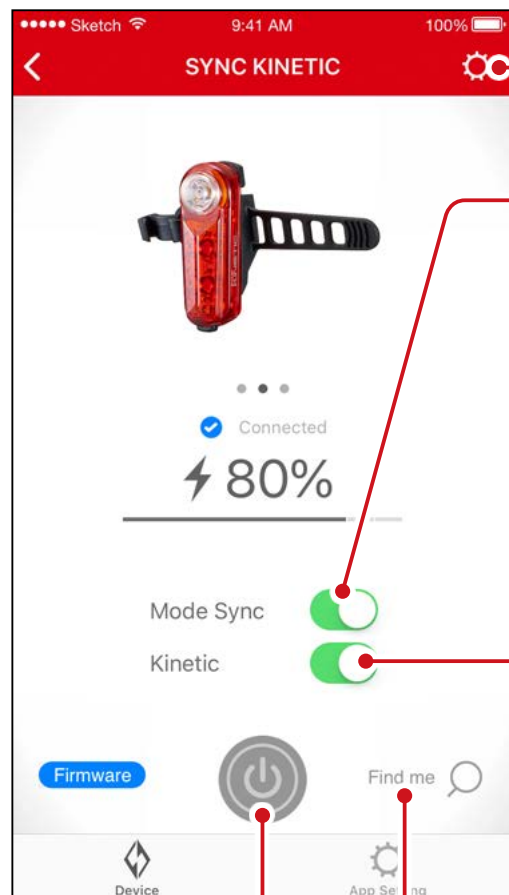

Tap to go to the setting screen

### Mode Sync

Turn on/off synchronization of mode change.

\* On/off operation will remain synchronized even when Mode Sync is turned off.

### Kinetic

Turn on/off synchronization of Kinetic mode in rear lights. Kinetic mode is activated when deceleration is detected.

\* Connection of a light with kinetic function is required.

### Find me (\*) / Mode

\* The selected light will flash for several seconds.

### Switch

Press and hold to turn the light on/off.

## Setting screen (Taillight)

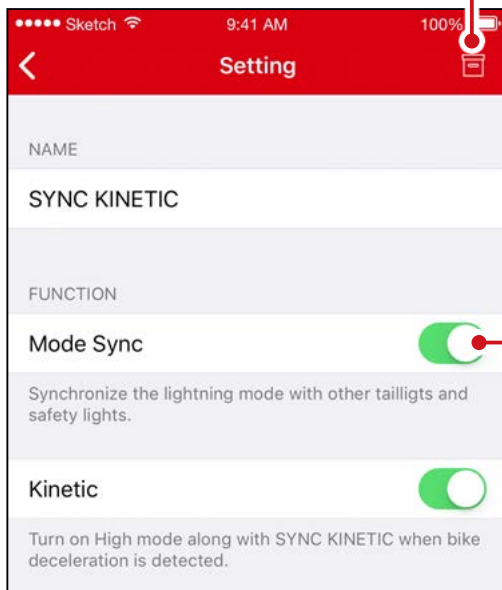

### Unpair icon

Unpairs the light.

\* Unpairing can also be performed by pressing and holding the switch on the light for 10 seconds.

### Mode Sync

## Setting screen (Safety Light)

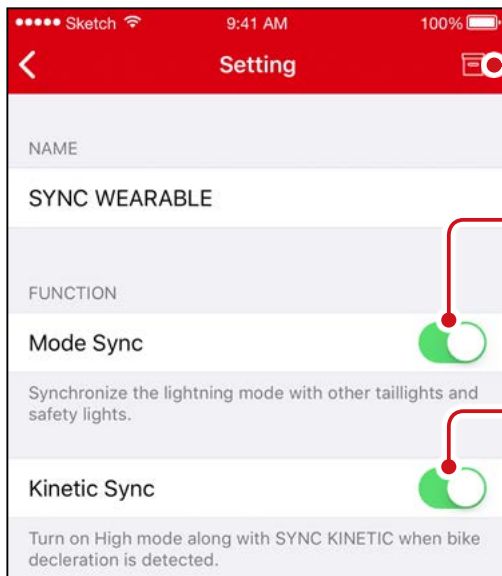

### Unpair icon

### Mode Sync

### KineticSync

\* The safety light itself does not have a kinetic function.

# Firmware Update

## Update Notifications

When a new firmware version is available, CatEyeSYNC™ will show a notification.

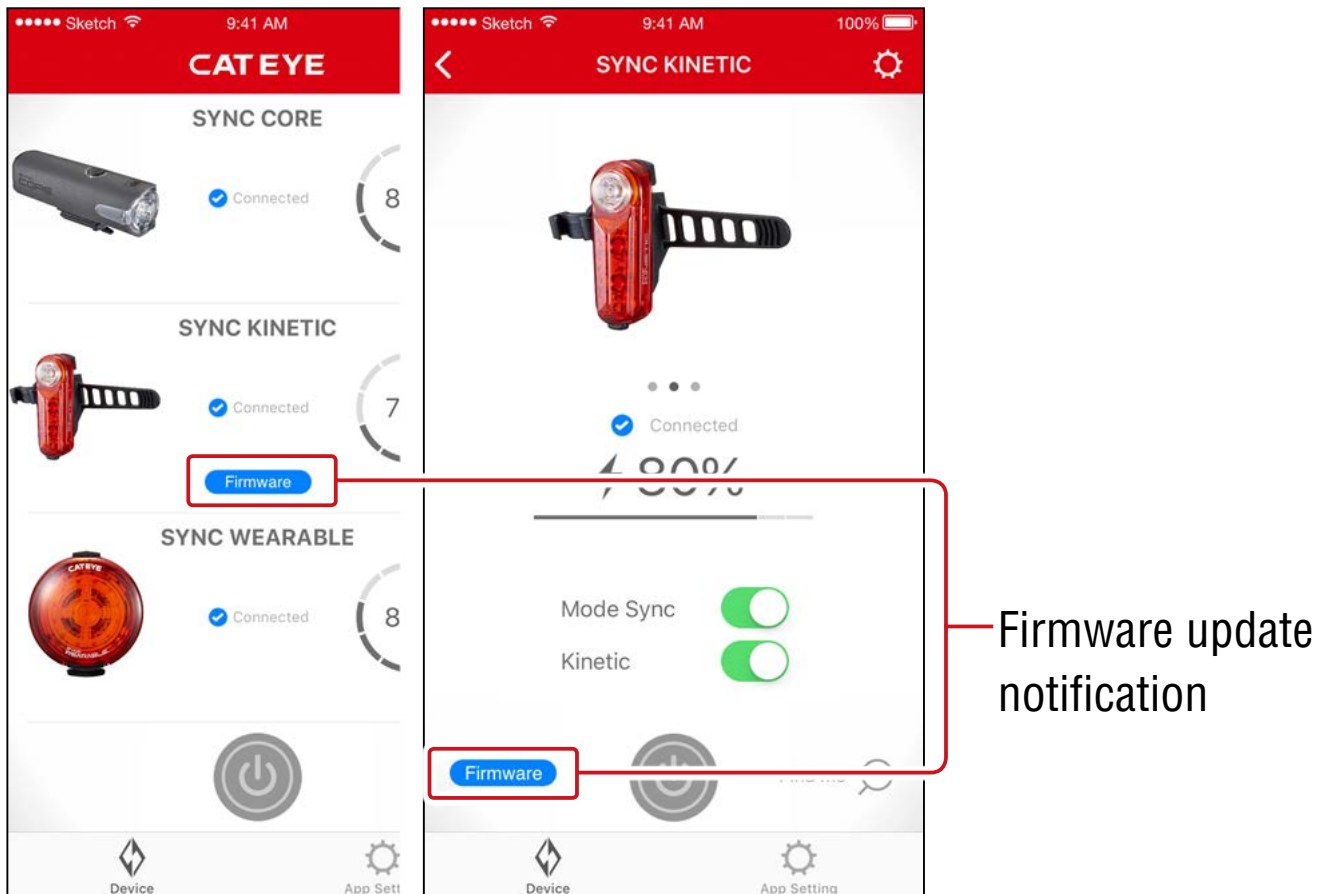

## Installing and Executing Firmware Updater for CatEyeSYNC™

To update the firmware, install Firmware Updater for CatEyeSYNC™ on your PC.

\* The PC must be connected to the Internet.

**Operating environment : Windows 7 / 8 / 8.1 / 10, or  
Mac OS 10.10 or later**

# 1. [Download the updater](#) from the CATEYE website.

## Download location

---

Home page

---

> SUPPORT

---

> Downloads

---

> Software and App

---

> Firmware Updater for CatEyeSYNC™

---

# 2. Download the Firmware Updater for CatEyeSYNC™ that matches your OS.

After download is complete, follow the on-screen instructions to install.

## Executing Firmware Updater for CatEyeSYNC™

\* The PC must be connected to the Internet.

### 1. Fully charge the light being used.

**Important : Please make sure the light is fully charged before updating the firmware.**

### 2. Start Firmware Updater for CatEyeSYNC™.



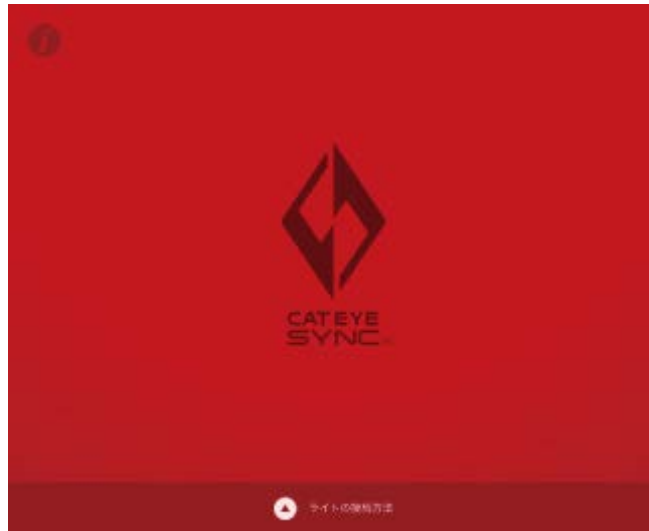

### **3. Follow the on-screen instructions to connect the light to a PC and update the firmware.**

- Important :**
- Be sure to use the included USB cable when connecting a light to a PC.
  - Do not simultaneously connect any other lights.
  - Do not power off the PC or disconnect the light while updating. Doing so may damage the light.

Click [Update] button to begin updating. Wait until a dialog appears with the message [Updating complete].

### **4. After the update is complete, disconnect the light.**

After updated, the light will enter a sleep state.

Click the switch on the light to wake the light.

# Frequently Asked Questions

## General Knowledge and Use

### **What is CatEyeSYNC™?**

CatEyeSYNC™ is an app that enables synchronization of multiple lights when used with paired CatEyeSYNC™-compatible lights. In addition to synchronization of the on/off operation and mode switching for paired lights, CatEyeSYNC™ can also be used to customize light modes and to check the remaining battery level of lights.

### **Will the lights be synchronized even when the light is disconnected from CatEyeSYNC™?**

All paired lights will remain synchronized even when CatEyeSYNC™ is not open.

### **How do I connect a paired light to CatEyeSYNC™?**

Simply open CatEyeSYNC™ to connect the light.

\* Connection can be established even when CatEyeSYNC™ is only running in the background.

## How do I add a light purchased later?

From the CatEyeSYNC™ home screen, tap [+] to begin pairing. For details, refer to [“Pairing with a Light” \(page 3\)](#).

## Can I turn off synchronization of a specific light?

Press and hold the switch on the light for 3 seconds.

The LED on the light will flash three times, forcing the light into a sleep state. In this state, the light is not connected to CatEyeSYNC™ or other lights.

To reconnect the light, click the switch on the light. The LED on the light will flash three times to show that connection to CatEyeSYNC™ and other lights is possible.

## When will notifications be displayed on the smartphone?

A notification is displayed when the remaining battery power is low and the indicator turns on, or when charging is complete and the charging indicator turns off.

\* Turn on “Lights Battery” notification in “App Setting”.

## Troubleshooting

### **The light does not connect to CatEyeSYNC™ or other lights, or is not synchronized.**

It is likely that the communication environment and the usage situation is preventing ON/OFF synchronization.

Directly operate the light failed in synchronization.

- \* Some usage situations may result in connection/synchronization taking a few moments.

After about 4 days without use, the light will enter a sleep state ([page 9](#)), which will prevent communication. If this happens, click the switch on the light to wake the light. The light can then be connected to CatEyeSYNC™ or other lights.

- \* The LED on the light will flash three times when the light wakes up.

### **The light cannot be connected to CatEyeSYNC.**

Restart the smartphone.

Is the smartphone OS (iOS/Android) up to date?

Connect the light to a PC and check for a firmware update using Firmware Updater for CatEyeSYNC™.

For details, refer to [“Firmware Update” \(page 15\)](#).

## The firmware update does not finish, or an alert is displayed.

Try updating the firmware again from the beginning.

- \* Please make sure the light is fully charged before updating the firmware.
- \* Be sure to use the included USB cable when connecting a light to a PC.
- \* Do not simultaneously connect any other lights.

- \* For information on charging the light or individual operations, refer to the “[Instruction Manual \(PDF\) for CatEyeSYNC™-Compatible Lights](#)”.

### **CATEYE CO., LTD.**

2-8-25, Kuwazu, Higashi Sumiyoshi-ku, Osaka 546-0041 Japan

Attn: CATEYE Customer Service

Phone : (06)6719-6863

Fax : (06)6719-6033

E-mail : support@cateye.co.jp

URL : <https://www.cateye.com>

### **[For US Customers]**

### **CATEYE AMERICA, INC.**

2825 Wilderness Place Suite 1200, Boulder CO 80301-5494 USA

Phone : 303.443.4595

Toll Free : 800.5.CATEYE

Fax : 303.473.0006

E-mail : service@cateye.com