



## RECHARGEABLE SAFETY LIGHT

# VIZ100<sup>TM</sup>II

MODEL : TL-LD801B

# VIZ150<sup>TM</sup>II

MODEL : TL-LD801

For your safety, please be sure to read the entire manual carefully and use the product correctly. Please keep the manual in a safe place where you can refer to it at any times. If the product is to be used by a child, the guardian should read the user manual and explain the safety instructions. This product is designed assuming use by bicycle.

TLLD801/801BENG-260608 1

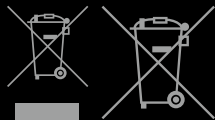

CATEYE will continue to contribute to society by creating new values in "Safety," "Health," and "Environment". CATEYE supports the Sustainable Development Goals movement proposed by the United Nations.

The USB cable is not included in the package because CATEYE is committed to making environmentally friendly and resource-saving products.

## COVER CONTENTS

PART NAMES AND PACKAGE CONTENTS  
HOW TO CHARGE →

SWITCH OPERATION →  
HOW TO MOUNT TO A BICYCLE →

DANGER / WARNING / CAUTION /  
DISPOSAL INSTRUCTIONS →  
BATTERY REPLACEMENT

SPECIFICATIONS  
STANDARD ACCESSORIES / →  
OPTIONAL ACCESSORIES

REGULATORY INFORMATION →  
LIMITED WARRANTY

# PART NAMES AND PACKAGE CONTENTS

## Light unit

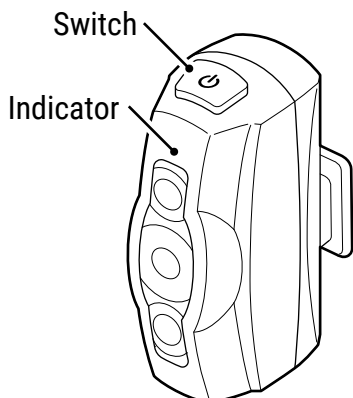

## Rubber band and hook (For rear)

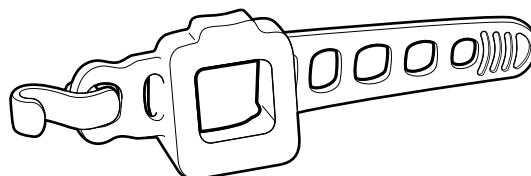

# HOW TO CHARGE

**!** Before using the product, refer to the “**⚠ DANGER / WARNING / CAUTION**” (page 4) section and charge the battery.

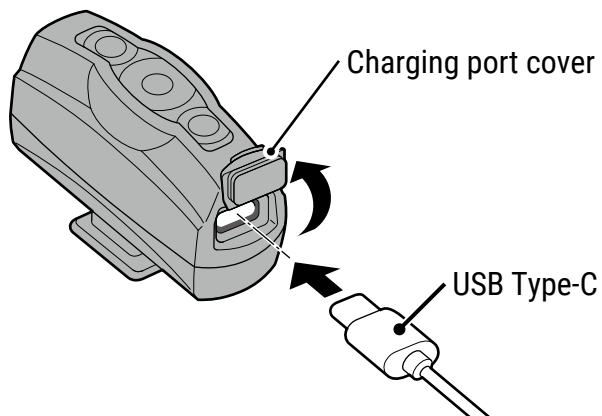

\* Please prepare a USB cable (Type-C) that can be used for charging (sold separately) before using this product.

\* This unit is shipped with small charge to check the light.

<b>Indicator</b>	Constant red light	Off
<b>Charging status</b>	Charging	Charging is completed

**Charging time : Approx. 3 hours (0.5 A)**



# SWITCH OPERATION

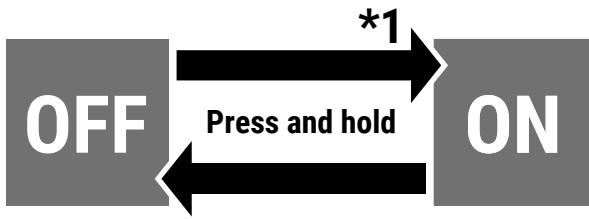

\*1 : When turning the light on, it illuminates in the mode that was last used. (Mode memory function)

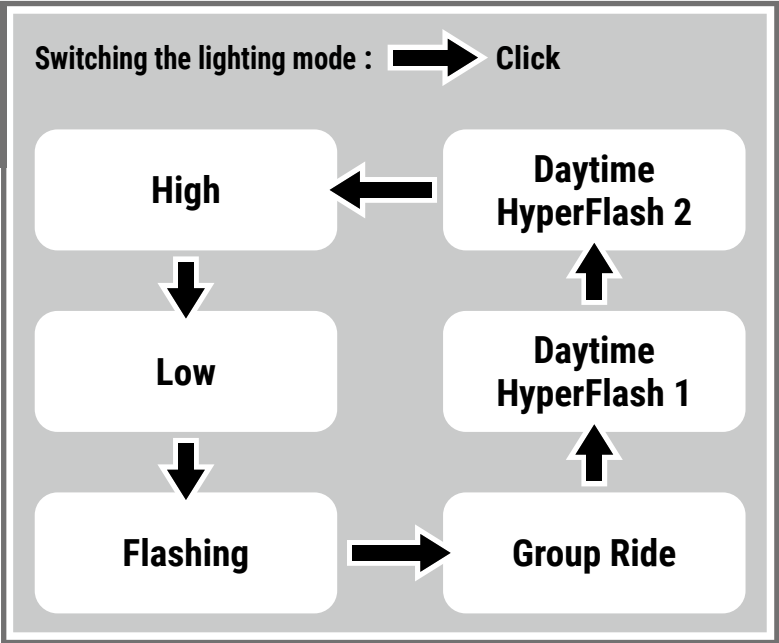

## Automatic battery-saving function

When the remaining battery power gets low, the indicator starts flashing and the lighting mode changes to power-save flashing mode (where the LEDs on both ends of the unit flash alternately). Charge the product as soon as possible.

\* Run time is approximately 1 hour in power-save flashing mode.

# HOW TO MOUNT TO A BICYCLE

Attach securely in the mounting position.

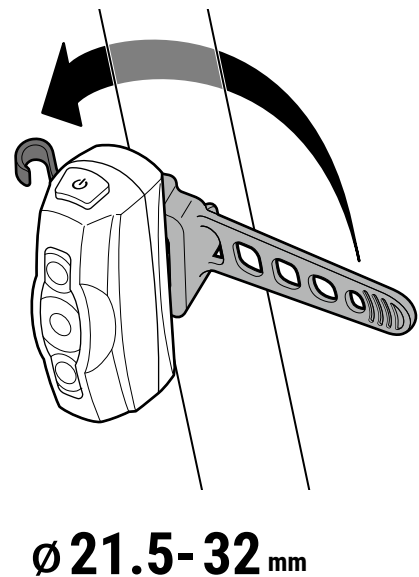
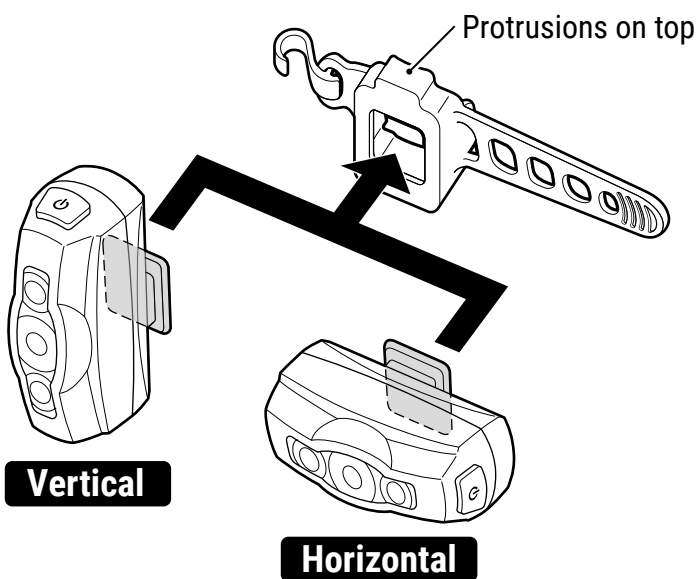

## **DANGER!!!**

- Using or storing the battery in high temperatures will accelerate its degradation. Do not place the product inside a vehicle or near a heater.
- Please make sure to charge in an environment between 5°C and 40°C.
- Do not subject the product to strong vibrations, impacts, or excessive force.
- Do not charge the product, insert or remove the USB plug, or replace the battery with wet hands or a wet product.
- Do not charge or use the battery at any voltage or polarity other than that specified. Do not short-circuit the battery.
- Keep the product out of reach of children.
- Do not disassemble or modify the product or any of the included items. Also, do not use damaged products or parts.
- Do not place the product in fire or heat it.
- If you notice any abnormalities, stop using the product immediately.
- For your safety, please replace the batteries only after they are completely discharged. \*2

## **WARNING!!**

- Before riding, for safety reasons, please make sure that the light is securely mounted in a position where it does not block the beam and that it lights up properly.
- For safety reasons, operation should be performed with the bicycle stationary.
- Please check the indicator and brightness regularly and always keep an eye on the battery level.
- Please be sure that no dust or other foreign objects are attached to the plug of the USB cable before charging. Once charging is completed, be sure to disconnect the USB cable from the charging port.
- If rechargeable batteries are left unused for a long period of time, their voltage will drop and their performance will deteriorate. If the product will not be used for a long period, store it in not too hot or not too humid. Please charge it for approximately 30 minutes every 6 months.
- When removing the battery, please be careful not to damage it, drop it, apply strong impact, or cut the cables. \*2

## **CAUTION!**

- To maintain the waterproof performance, make sure the cover of the battery compartment and the charging port should be securely closed. Also, make sure to wipe off any moisture thoroughly after using the product in the rain.
- To prevent damage to the product, do not apply excessive force to the charging port.
- Charging and lighting times are approximate and may vary depending on the usage environment.
- If the illumination time is significantly reduced even after charging, it may be due to the battery's degradation and end of its service life.
- When removing or installing batteries, please be careful not to injure your finger. \*2
- If the battery is leaking, do not touch the leaked liquid. If you accidentally come into contact with leaked battery fluid, wash it off immediately with running water. \*2

## **DISPOSAL INSTRUCTIONS**

When disposing the light unit, please do so in accordance with your local regulations.

\*2 : For EU battery regulation.

# BATTERY REPLACEMENT (For EU battery regulation)

**⚠️** Lithium-ion rechargeable batteries may explode or catch fire if not handled properly. For details, please refer to “⚠️ **DANGER / WARNING / CAUTION**” (page 4).

**1** Remove the screw and detach the housing from the battery unit. Then, slide the battery holder attached to the battery toward the switch.

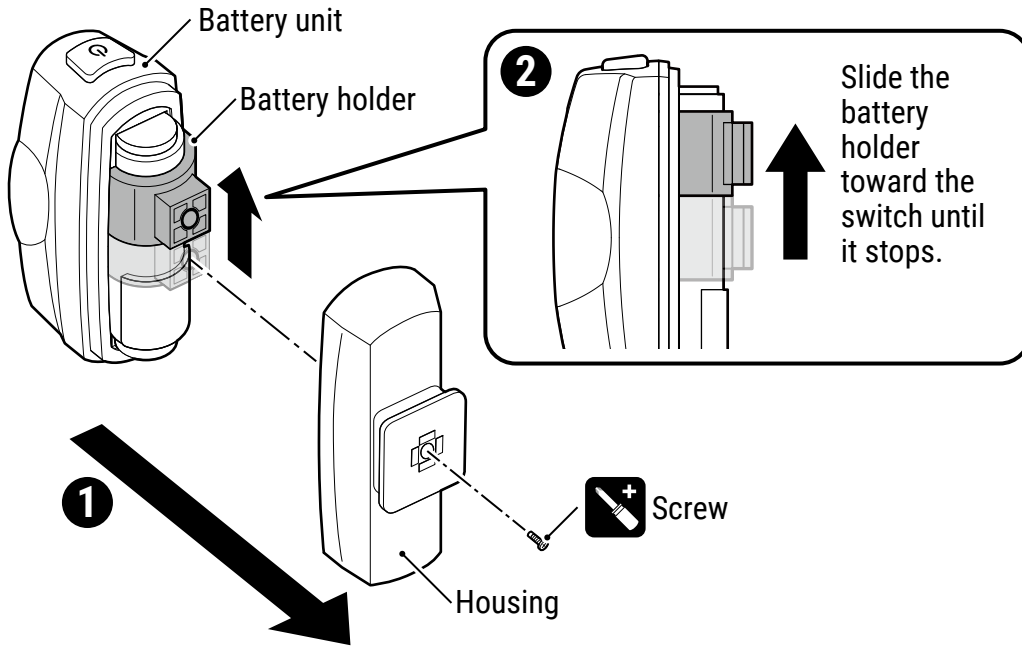

**⚠️ Regarding battery replacement**

Please replace the battery correctly according to this manual. Failure to do so may result in unexpected injury, malfunction, or a decrease in water resistance. Also, please use genuine parts. For genuine parts, please contact your dealer.

**⚠️ Battery replacement precautions**

For your safety, please replace the batteries only after they are completely discharged.

**⚠️ Tool usage precautions**

When using tools, please be careful not to damage components.

**⚠️ Battery installation and removal precautions**

When disconnecting battery wiring, please be careful not to damage the cables.

**⚠️ Do not use after dropping or impact**

Do not drop the battery or subject it to strong impact. Do not use the battery if it has been dropped or subjected to impact.

**2** Remove the old battery before removing the battery holder. Attach the removed battery holder to the new battery.

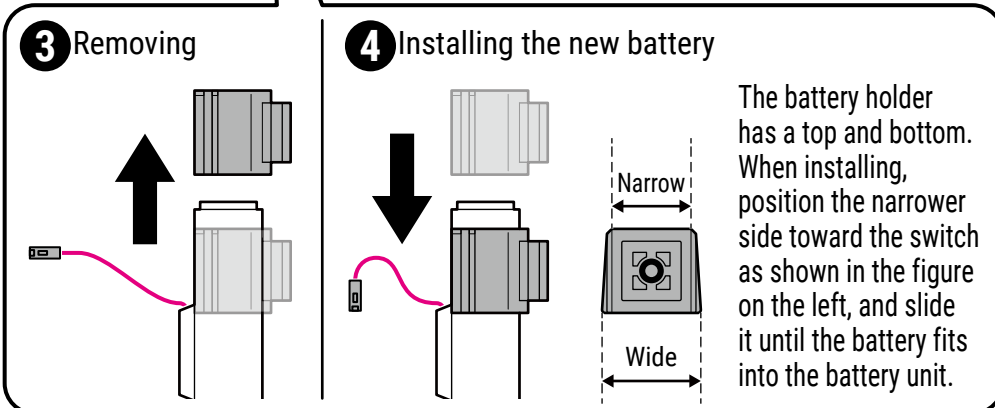
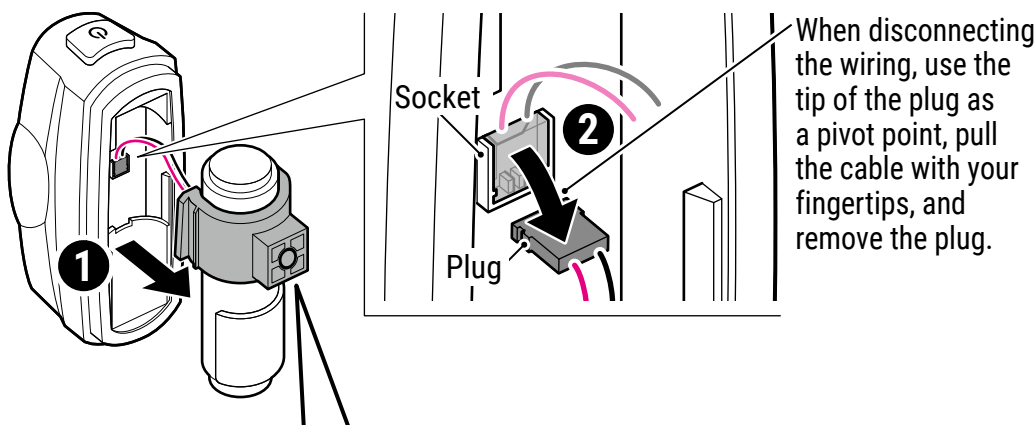

**3** Install the battery into the battery unit.

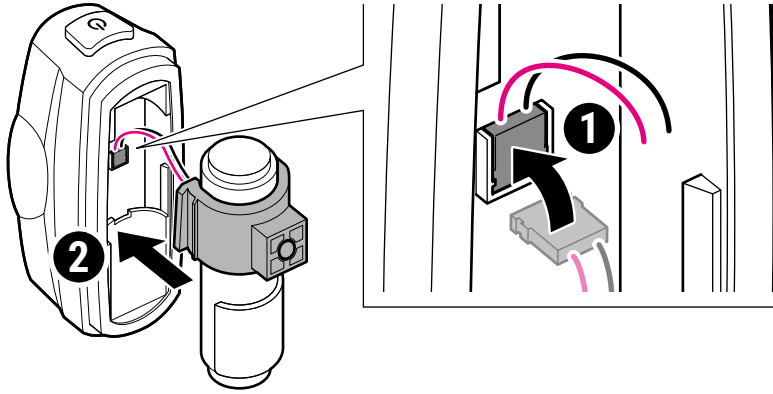

When connecting the wiring, align the plug and socket, and use the tip of the plug as a pivot point with your fingertips, just as you did when disconnecting it, to securely connect the plug.

**⚠ Battery installation and removal precautions**

When installing the battery, please be careful to insert it in the correct orientation to avoid short circuits.

**⚠ Precautions During Installation**

When installing the battery, be careful not to damage the cables.

**4** Slide the battery holder toward the opposite side of the switch. After attaching the housing to the battery unit, securely tighten the screws.

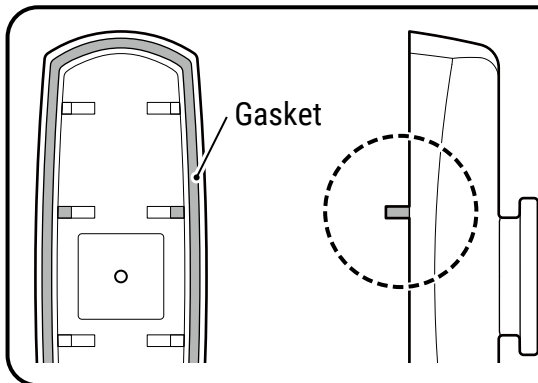

When attaching the housing, ensure that the inner gasket is installed without any gaps and that no foreign objects are adhering to it. Also, note that the housing has a top and bottom. Install it with the side featuring the long protrusion on the inside facing the switch. If the orientation is incorrect, it will not fit onto the battery unit.

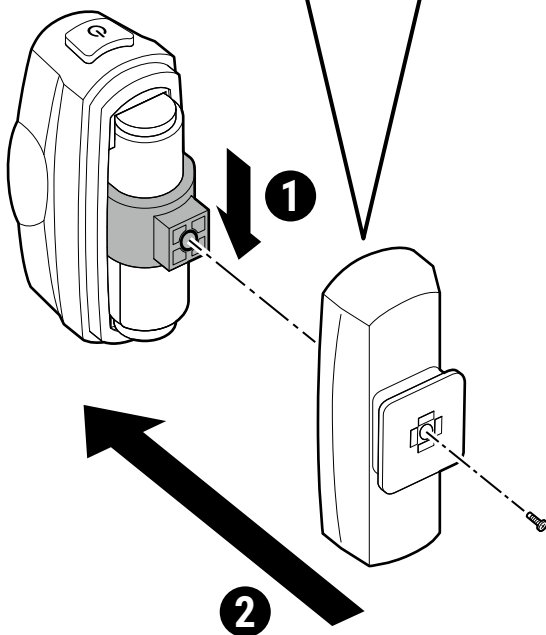

# SPECIFICATIONS

<b>Light source</b>	LED x 3
<b>Battery type</b>	Li-ion 3.7 V 500 mAh
<b>Charge terminal</b>	USB Type-C
<b>Operating time <sup>*3</sup></b>	High : Approx. 5 hours Low : Approx. 10 hours Flashing : Approx. 70 hours Group Ride : Approx. 50 hours Daytime HyperFlash 1 : Approx. 15 hours Daytime HyperFlash 2 : Approx. 15 hours
<b>Charging time</b>	Approx. 3 hours (0.5 A)
<b>Charge voltage</b>	5 V
<b>Temperature range</b>	Charging : 41°F – 104°F (5°C – 40°C) , Operating : 14°F – 104°F (-10°C – 40°C)
<b>Waterproof</b>	IPX 4
<b>Recharge / discharge number of times</b>	About 300 times (until the rated capacity drops to 70%)
<b>Dimensions / Weight</b>	7/8" x 2-35/64" x 1-15/32" (22.5 x 65 x 37.5 mm) / 1.15 oz (32.5 g)

\*3 : Approximate average runtime at 68°F (20°C).

\* The specifications and design are subject to change without notice.

# STANDARD ACCESSORIES

**5342380 Rubber band and hook**  
(For rear)



# OPTIONAL ACCESSORIES

**5342550 USB cable**  
(Type-A ↔ Type-C)



**5342280 Bracket**  
(SP-11 : FlexTight™)

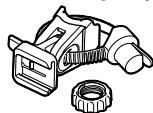

**5342410 Bracket**  
(SP-12-R : FlexTight™)

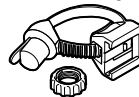

**5440900N Clip**  
(C-1N)

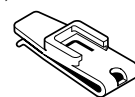

**5342460 Clip**  
(C-2)

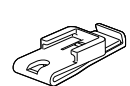

**5342490 Bracket**  
(SP-15)

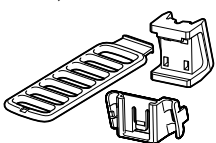

**5446510 Bracket**  
(RM-1 : For Saddle Rail)

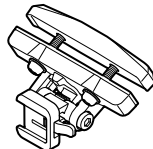

**5445620 Bracket**  
(Rear Rack)

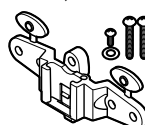

**5342250 Bracket**  
(Rear Rack)

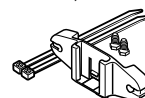

**3980060 Bracket**  
(SR-2 : Fizik Saddle Rail)



\* To prevent accidents and malfunctions, use only genuine parts for installation.



# REGULATORY INFORMATION

This device complies with Part 15 of the FCC Rules. Operation is subject to the following two conditions:

- (1) This device may not cause harmful interference, and
- (2) This device must accept any interference received, including interference that may cause undesired operation.

This equipment has been tested and found to comply with the limits for a Class B digital device, pursuant to part 15 of the FCC Rules. These limits are designed to provide reasonable protection against harmful interference in a residential installation. This equipment generates, uses and can radiate radio frequency energy and, if not installed and used in accordance with the instructions, may cause harmful interference to radio communications. However, there is no guarantee that interference will not occur in a particular installation. If this equipment does cause harmful interference to radio or television reception, which can be determined by turning the equipment off and on, the user is encouraged to try to correct the interference by one or more of the following measures:

- Reorient or relocate the receiving antenna.
- Increase the separation between the equipment and receiver.
- Connect the equipment into an outlet on a circuit different from that to which the receiver is connected.
- Consult the dealer or an experienced radio/TV technician for help.

CAN ICES-3(B)/NMB-3(B)

## LIMITED WARRANTY

### **2-year Warranty: Light unit only (excludes battery deterioration)**

CatEye products are warranted to be free of defects from materials and workmanship for a period of 2 years from the original purchase date.

If the product fails to work during normal use, CatEye or an authorized retailer will repair or replace the product at no charge (proof of purchase is required.)

Please note that even if the product is within the warranty period, it may not be covered by the warranty depending on the condition of the product and the conditions of use.

## **CATEYE CO., LTD.**

2-8-25, KUWAZU, HIGASHI SUMIYOSHI-KU, OSAKA, JAPAN 546-0041

For inquiries, please visit <https://cateye.com/intl/contact>  
[globalservice@cateye.co.jp](mailto:globalservice@cateye.co.jp)



Contact Form

### **[For US Customers]**

CATEYE AMERICA, INC.

Please visit <https://www.cateyeamerica.com>

Toll Free : 800.5.CATEYE

