

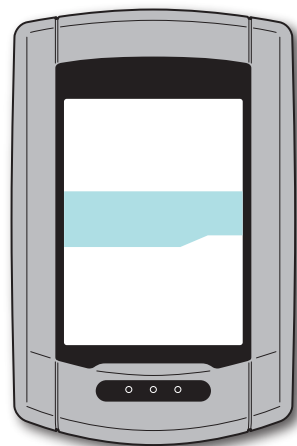

CATEYE STEALTH 10

CYCLOCOMPUTER CC-GL10

ENG



Instruction manual



Before using the computer, please thoroughly read this manual and keep it for future reference.

- * This PDF contains a link to YouTube.
When you click on the button “Watch a video”, a message regarding security appears.
Click the “Allow” to open a browser and play the video.
- * YouTube videos and instruction manuals related to this product are subject to change without notice.
For the latest edition of the instruction manual (PDF), visit the official Cat-Eye website.
- * This manual has been prepared on the assumption that the user has sufficient basic knowledge, including operation and terminology of PCs (Windows / Mac).

Features of this unit

Measurement method

This unit is a cyclocomputer, having a GPS and acceleration sensor built-in, which can perform measurement by receiving GPS signal, without speed sensor.

Recording and viewing the trip route

Position information from GPS is recorded with measurement data during measurement. The measurement data such as your route and altitude can be viewed as a trip on a map on the site, by loading them into the dedicated software application “CATEYE Sync™” on your PC, and then uploading to the special website “CATEYE Atlas™”. “CATEYE Atlas™” can be used as a database for your cycling life, where you can store the trips measured using this unit or CATEYE INOU, a trip recorder with camera.

This device complies with Part 15 of the FCC Rules and Industry Canada licence-exempt RSS standard(s). Operation is subject to the following two conditions: (1) this device may not cause harmful interference, and (2) this device must accept any interference received, including interference that may cause undesired operation.

L'appareil est conforme à la réglementation FCC, section 15 et Industrie Canada RSS standard exempts de licence (s). Son utilisation est soumise à deux conditions :

1. *L'appareil ne doit pas provoquer d'interférences nuisibles, et*
2. *L'appareil doit supporter les interférences reçues, y compris les interférences empêchant son fonctionnement correct.*

Modifications

The FCC requires the user to be notified that any changes or modifications made to this device that are not expressly approved by CatEye Co., Ltd. may void the user's authority to operate the equipment.

NOTE: This equipment has been tested and found to comply with the limits for a Class B digital device, pursuant to Part 15 of the FCC Rules. These limits are designed to provide reasonable protection against harmful interference in a residential installation. This equipment generates, uses and can radiate radio frequency energy and, if not installed and used in accordance with the instructions, may cause harmful interference to radio communications. However, there is no guarantee that interference will not occur in a particular installation. If this equipment does cause harmful interference to radio or television reception, which can be determined by turning the equipment off and on, the user is encouraged to try to correct the interference by one or more of the following measures: Reorient or relocate the receiving antenna. Increase the separation between the equipment and receiver. Connect the equipment into an outlet on a circuit different from that to which the receiver is connected. Consult the dealer or an experienced radio/TV technician for help.

This Class B digital apparatus complies with Canadian ICES-003.

Cet appareil numérique de la classe B est conforme à la norme NMB-003 du Canada.

Proper use of the CatEye STEALTH 10

Warning / Caution

- Do not concentrate on the computer while riding. Ride safely!
- Mount firmly the bracket on your bicycle, and check periodically that it is not loosened.
- Do not leave the computer in direct sunlight for a long period of time.
- Do not disassemble the computer.
- Do not drop the computer to avoid malfunction or damage.
- Be sure to tighten the dial of the FlexTight™ bracket by hand. Tightening it strongly using a tool, etc. may damage the screw thread.
- When cleaning the computer and bracket, do not use thinners, benzene, or alcohol.
- LCD screen may be distorted when viewed through polarized sunglass lenses.

Cautions when measuring

Press and hold the **MODE** button to reset the computer before and after measurement. Measuring starts by resetting the computer. The unit keeps recording the trip until it is reset. Turn off the unit when not in use.

GPS

GPS (Global Positioning System) is a system to identify the current position on the earth by receiving highly precise positional information sent from a satellite.

Receiving the GPS signal

- It may take several minutes to acquire the GPS signal after turning on the computer.
- While searching the GPS signal, we recommend that you do not move around until receiving the GPS signal. It may take more time to receive the GPS signal if you move around while searching the GPS signal.
- Receiving the GPS signal becomes easier under such conditions that the sky is open and the prospect for the satellites is good.

Where the GPS signal cannot be received

GPS signal may not be received, thus the unit may stop measurement or may not display appropriate measurements in the following locations or environments.

- In a tunnel, underground and building, between high-rise buildings, under an elevated structure and arcade, etc.
- In bad weather (snow, rain, etc.)
- Near a high-voltage line or a mobile telephone relay station.
- When the computer display does not face to the sky.

* The measuring result may differ slightly from the actual value, since this unit calculates the speed from GPS signal.

Battery

Follow these instructions to maximize the lithium-ion battery performance.

Recharge the battery for first time use or after long period of storage

Each battery has a rate of self-discharge and the voltage of the battery may drop during long period of storage.

Always fully charge the battery before use.

Cautions on recharging

- Charge the battery at ambient temperature between 41°F to 104°F (5°C to 40°C).
- Be sure to unplug the USB plug after charging is completed.
- Clean the USB plugs before charging.
- Do not apply vibration during charging.
- When the connected PC is in sleep state, the battery cannot be charged.

Cautions in use

- Charging, discharging and storing at high temperature will damage the battery. Do not leave the battery in a car or near a heater.
- When the lighting time decreases significantly even though it is charged correctly, the rechargeable battery has reached the end of its usable life due to deterioration. For details, see “How to dispose the computer” (page 27).

Cautions on storage

Do not store the Li-Ion battery after a full charge. Cool and dry storage is recommended. For a long period storage, it is important to charge the battery 10 minutes every 6 months.

Cautions for dispose

Remove the rechargeable battery inside, before disposing the computer. For details, see “How to dispose the computer” (page 27).

Description of computer and its parts

Computer

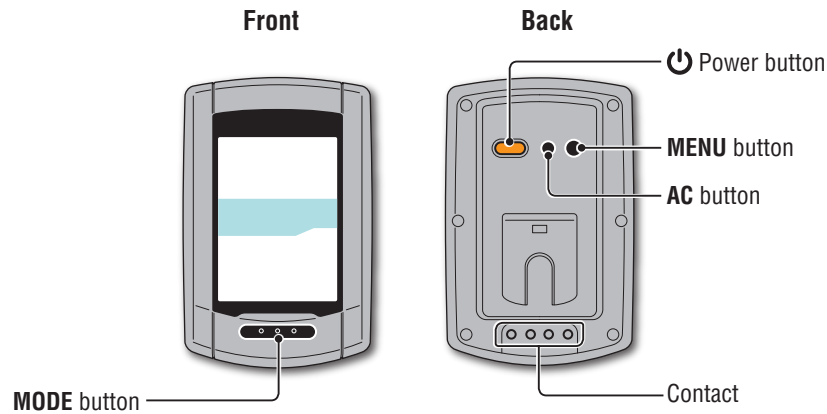

Accessories

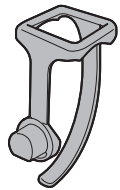

Bracket band

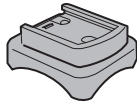

Bracket



Bracket rubber pad



Dial

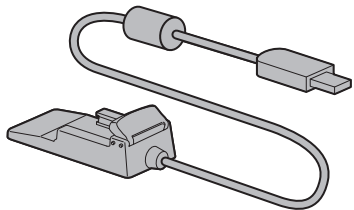

Cradle



Quick start
Yellow card

Screen display

Current speed
0.0 (3.0) - 105.9 km/h
[0.0 (2.0) - 65.9 m/h]

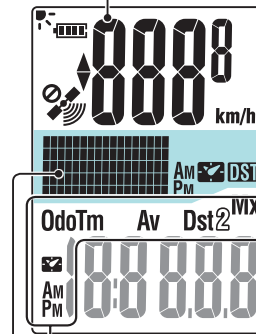

Selected data icon
Indicates the data displayed on the lower display.

Dot display
Displays mainly the clock.

Icon	Description
	Battery icon Displays the remaining battery capacity in 5 levels. * For information on how to charge the battery, see "How to turn on/off the power / how to charge the battery" (page 5).
	Remaining battery capacity is large.
	Remaining battery capacity is small.
	Remaining battery capacity is nearly zero. In such case, the computer turns off the power automatically. Charge the battery as soon as possible.
	Pace arrow Indicates if the current speed is faster or slower than the average speed. (▲ Faster, ▼ Slower)
	GPS signal receiving icon Indicates the GPS signal receiving status.
	GPS signal is strong.
	GPS signal is weak.
	GPS signal non-receiving icon Flashes when GPS signal cannot be received. In such status, measurement cannot be performed. * When such status lasts for 10 minutes, the computer turns off the power automatically. (Auto power off)
	Speed unit Flashes while speed measurement is in progress.
	Daylight saving time icon * For information on how to set the daylight saving time, see "Changing the computer configuration" (page 20).

How to install the unit on your bicycle

Watch video
(YouTube)

Click the button, then a browser will open and a video will be played back.

Attach the bracket to the stem or handlebar

The FlexTight™ bracket can be attached to either the stem or the handlebar, depending on how the bracket fits into the bracket band.

⚠ Caution: Be sure to tighten the dial of the FlexTight™ bracket by hand. Tightening it strongly using a tool, etc. may damage the screw thread.

When attaching the FlexTight™ bracket to the stem

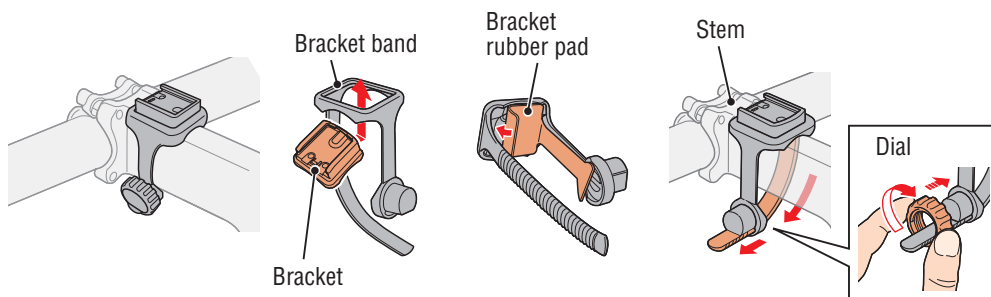

When attaching the FlexTight™ bracket to the handlebar

* To receive GPS signal effectively, adjust the direction of the bracket so that the computer display faces to the sky.

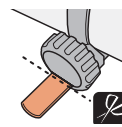
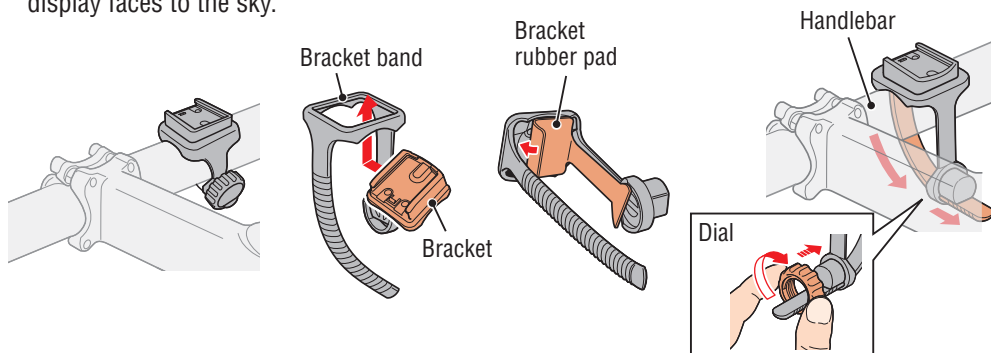

Cut the excess length of the band using scissors.

⚠ Caution: Round off the cut edge of the bracket strap to prevent injury.

* To mount the bracket to an aero-shaped handlebar or larger stem, use the optional nylon ties bracket.

Remove/Install the computer

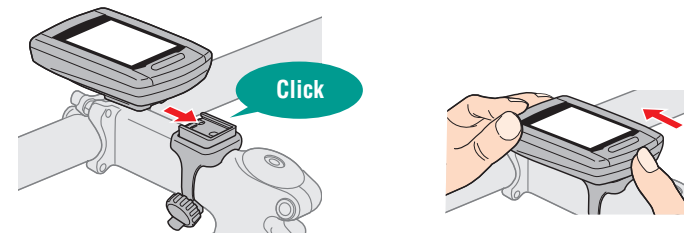

⚠ Caution: When removing, hold the unit to prevent it from falling.

How to turn on/off the power / how to charge the battery

Power ON/OFF

Press and hold the  button on the back of the computer for 2 seconds.

- * Set up the computer when you turn on the power for the first time. For details, see “Setting up the computer” (on the right of this page).
- * When the remaining battery capacity is small, charge it according to the following instructions.

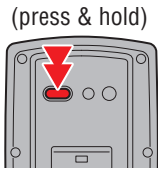

How to charge

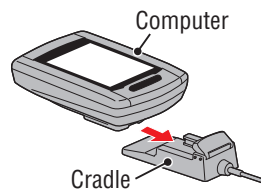

1 Set the computer to the cradle

⚠ Caution: Do not set wet computer to the cradle, for example after ride in the rain. It may cause short circuit and damage the computer or the data.



2 Insert the USB plug in your PC or a commercial USB battery charger

Once charging is started, only  (battery icon) is displayed.

Icon	Description
 (Animation)	Charging
 (Light up)	Charging is completed

- * When the computer is connected to your PC, the battery cannot be charged with the PC in sleep state.
- * With USB1.0, it takes time to charge.
- * The battery charges to about 80% after approximately 90 minutes.
- * The standard charging time may change according to the environment for use.
- * The computer can be used for 10 hours on a full charge.

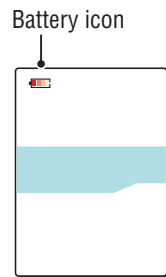

Standard charging time
Approx. 5 h

3 Remove the computer after charging is completed

Disconnect the USB plug from your PC or a USB battery charger, and then remove the computer from the cradle.

- * To remove the computer, press it out by hand while holding the cradle.

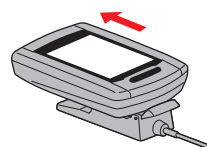

Setting up the computer

Perform the following formatting operation, when you use the unit for the first time or restore the unit to the condition before shipment.

⚠ Caution: All data are deleted, and the computer is reset to the factory default.

- * To complete the setting up quickly, press the **MENU** button twice after the formatting operation to stop setting up the computer. Then, you can set up quickly using your PC, by changing the computer configuration using the special software application “CATEYE Sync™”. For details, see “Changing the computer configuration” (page 20).

1 Format (initialize)

Press the **MENU** button on the back of the computer and the **AC** button simultaneously. Release the **MENU** button when a test pattern is displayed on the screen.

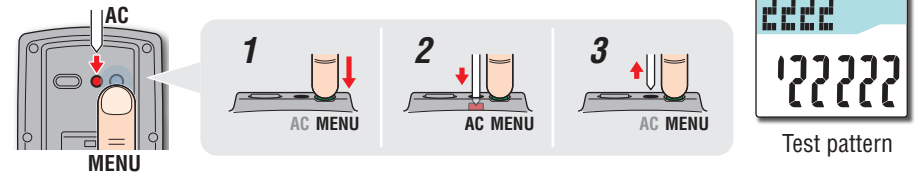

- * When all screen items light up without any test pattern displayed on the screen, the formatting operation has not been completed properly. Perform the formatting operation again.

Watch video
(YouTube)

Click the button, then a browser will open and a video will be played back.

2 Select the speed unit

Select “km/h” or “m/h”.



3 Select the time zone

In reference to the following “Time zone list”, select the code for the city nearest from your current location.



Switch the display



Register the setting (press & hold)

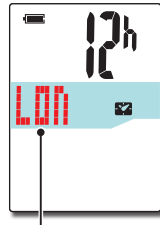

City code

Time zone list

City code	City name	Time difference
LON	London	0
PAR	Paris	+1
ATH	Athens	+2
MOW	Moscow	+3
THR	Tehran	+3.5
DXB	Dubai	+4
KBL	Kabul	+4.5
KHI	Karachi	+5
DEL	Delhi	+5.5
DAC	Dhaka	+6
RGN	Yangon	+6.5
BKK	Bangkok	+7
HKG	Hong Kong	+8
TYO	Tokyo	+9

City code	City name	Time difference
DRW	Darwin	+9.5
SYD	Sydney	+10
NOU	Noumea	+11
WLG	Wellington	+12
PPG	Pago Pago	-11
HNL	Honolulu	-10
ANC	Anchorage	-9
LAX	Los Angeles	-8
DEN	Denver	-7
CHI	Chicago	-6
NYC	New York	-5
CCS	Caracas	-4
RIO	Rio de Janeiro	-3

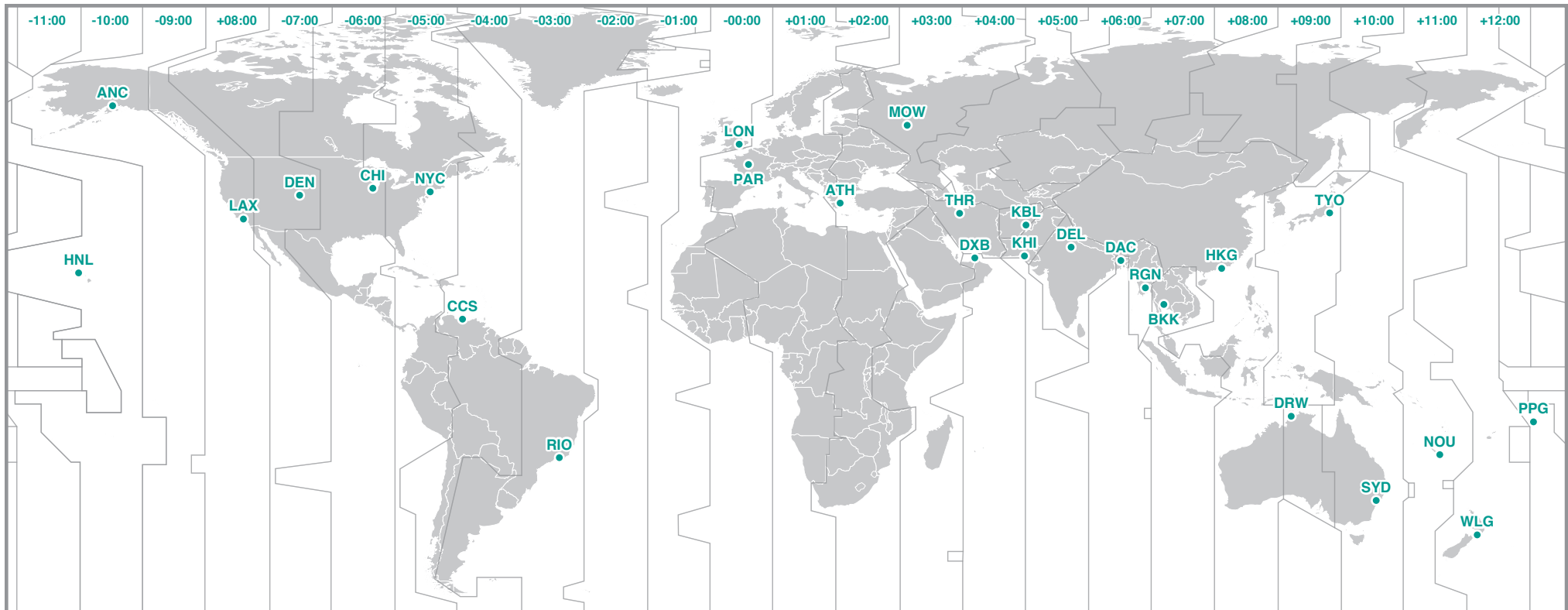

4 Select the daylight saving time

You can set the daylight saving time when you are on Daylight Saving Time.
Select ON or OFF.

Setting	Description
ON	Displays 1 hour faster than regular clock.
OFF	Displays in regular clock.

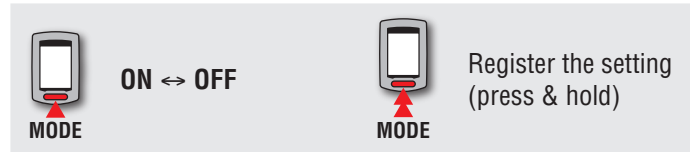

* Change ON/OFF according to the period of daylight saving time.

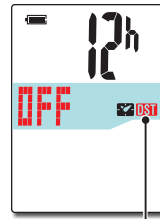

Daylight saving time icon

5 Select the clock display format

Select the display format of “12h” (12 hours display) or “24h” (24 hours display).

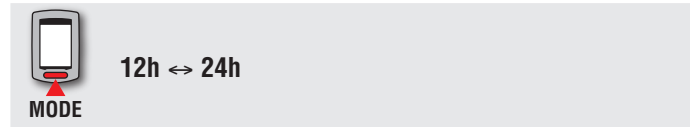

* Date and clock are acquired from GPS signal; therefore, it is not necessary to enter them.

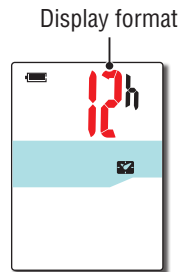

6 Press the MENU button to complete setting

Setting up is completed, and the computer changes to the GPS search screen.

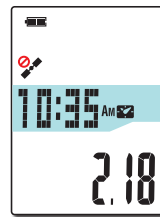
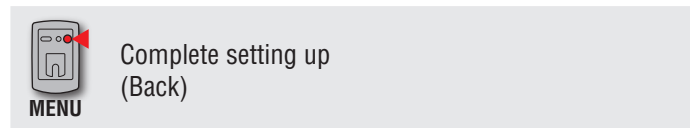

Now, setting up the computer is completed.
For information on how to use the computer, see “How to use the computer” (page 8).

How to use the computer

This unit is a sensor-less cyclocomputer using GPS. An environment where a GPS signal can be received is required for measurement. Three screens of GPS search screen, measurement screen, and standby screen are available in this unit, which are displayed alternatively according to the GPS receiving status and the bicycle operating status. This section describes the flow of the screen after the power is turned on until measurement is started.

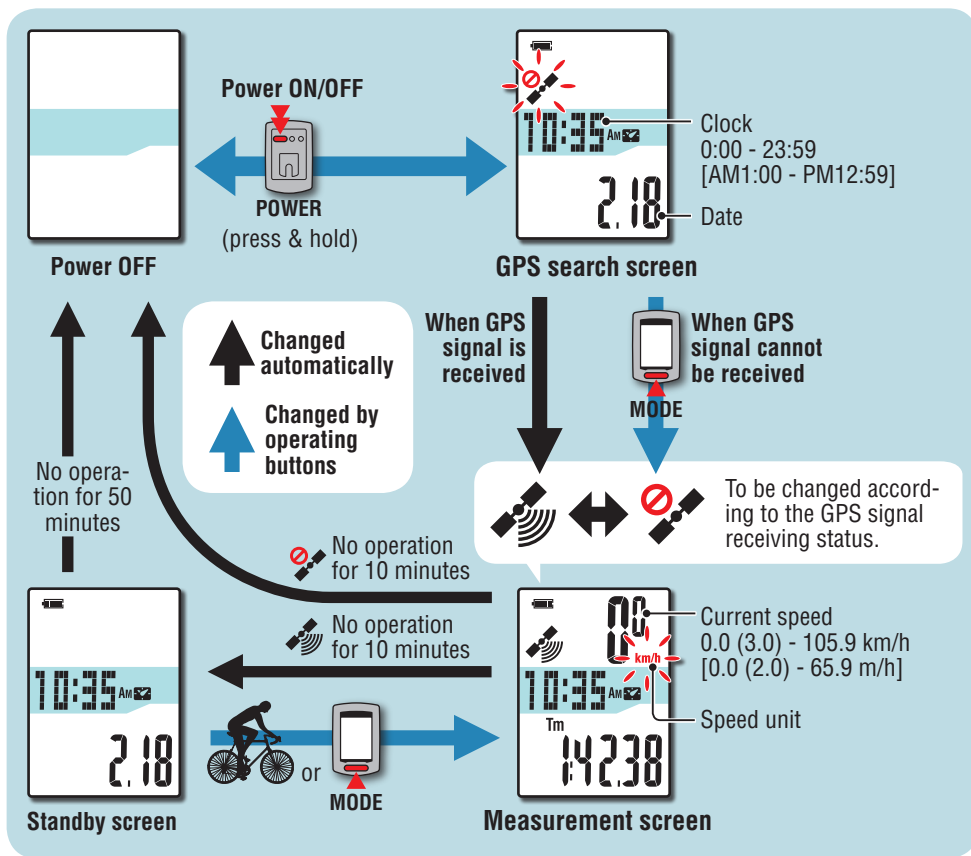

GPS search screen (when the power is turned on)

When the power is turned on, the GPS search screen will appear, and the GPS signal non-receiving icon (📶) will flash. Once GPS signal is received, the GPS signal receiving icon (📶) will light up, and the display will change to the measurement screen.

* In an environment, including indoor, where GPS signal cannot be received, press the **MODE** button to change to the measurement screen while the GPS signal non-receiving icon (📶) is still flashing.

* This unit starts searching GPS after the power is turned on. It may take several minutes to acquire GPS signal depending on the receiving status.

Measurement screen

This is the basic screen of this unit. This screen is used during measurement. You can start/stop measurement and view the data under measurement.

According to the GPS signal receiving status, the computer operates in a different way as follows.

* For the functions available on the measurement screen, see "Functions available on the measurement screen" (page 9).

When the GPS signal receiving icon (📶) lights up	When the GPS signal non-receiving icon (📶) flashes
<p>Measurement is enabled, and the unit starts/stops measurement in sync with the bicycle motion. The speed unit flashes during measurement.</p> <p>* If GPS signal cannot be received while riding, the GPS signal non-receiving icon (📶) will flash, and the unit will stop measurement.</p>	<p>In such status, measurement is disabled even while riding; however, only viewing the measurement data and the resetting operation are enabled.</p> <p>* Once GPS signal is received, the GPS signal receiving icon (📶) will light up, and measurement will be enabled.</p> <p>* The unit turns off the power automatically in 10 minutes without pressing any button in such status. (Auto power off)</p>

GPS signal may not be received, thus the unit may stop measurement or may not display appropriate measurements in the following locations or environments.

- In a tunnel, underground and building, between high-rise buildings, under an elevated structure and arcade, etc.
- In bad weather (snow, rain, etc.)
- Near a high-voltage line or a mobile telephone relay station.
- When the computer display does not face to the sky.

Standby screen

The unit changes to the standby screen automatically in 10 minutes without any bicycle motion or button operation, while the GPS signal receiving icon (📶) flashes on the measurement screen. Riding again returns to the measurement screen.

* The unit turns off the power automatically in 50 minutes with the standby screen displayed. (Auto power off)

* When the GPS signal cannot be received with the standby screen displayed, the GPS signal non-receiving icon (📶) flashes. In such a case, the computer does not return to the measurement screen even if you ride the bicycle.

Functions available on the measurement screen

Starting/Stopping measurement

⚠ Caution: Press and hold the **MODE** button to reset the computer before and after measurement. Measuring starts by resetting the computer. The unit keeps recording the trip until it is reset. Turn off the unit when not in use.

When the GPS signal receiving icon (📶) lights up, the unit starts/stops measurement in sync with the bicycle motion.

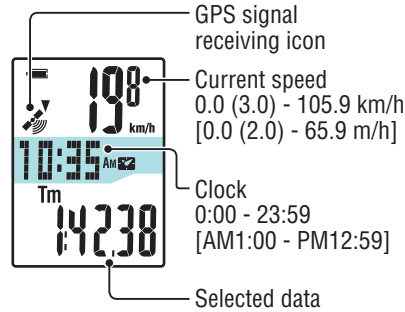

Switching computer function

Pressing the **MODE** button switches the measurement data in the lower display, in the order shown in the figure.

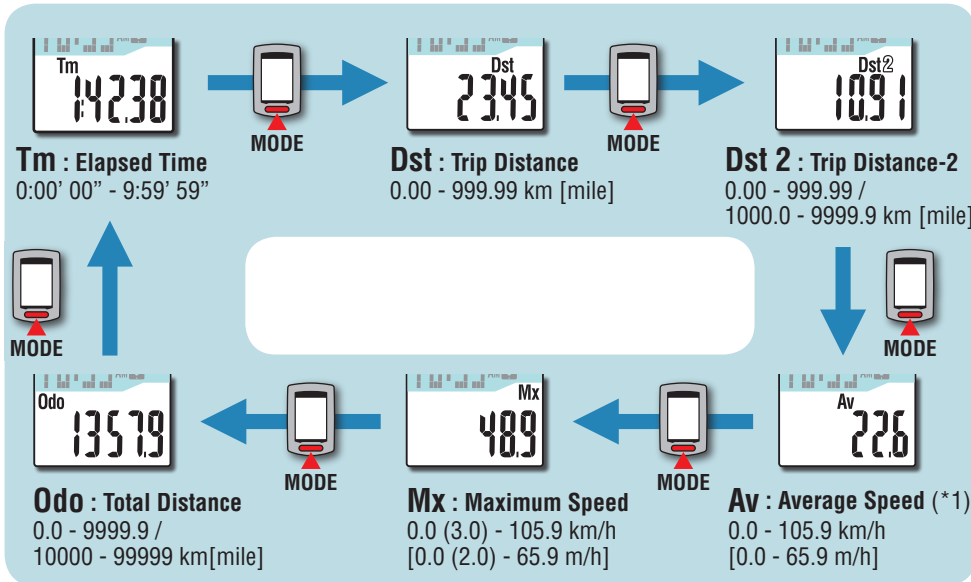

*1: When **Tm** exceeds about 27 hours, or **Dst** exceeds 999.99 km, Average Speed cannot be measured, while displaying ".E". Reset the data.

Backlight

When using it during night-time, the backlight always lights up.

Example: Setting of the night-time: 7:00 PM to 6:00 AM

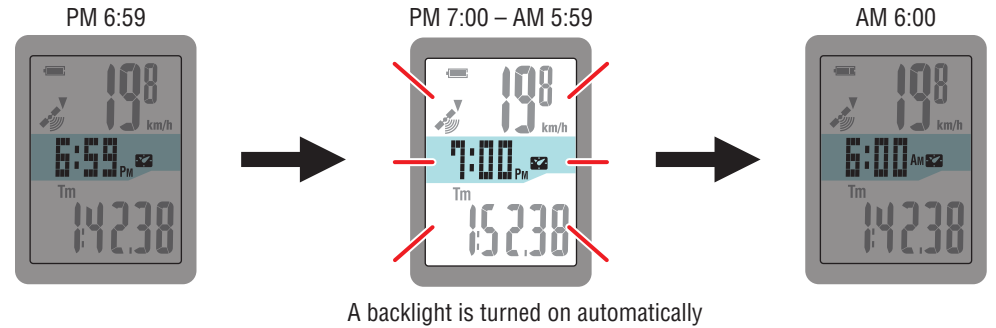

- * The night-time can be set to your needs. For information on how to set the night-time, see "Changing the computer configuration" (page 20).
- * As default, it is set to 7:00 PM to 6:00 AM.

Resetting the measurement data and generating the trip data

Holding down the **MODE** button with the measurement screen displayed resets the measurement data to 0 (resetting operation). All the measurement data up to that time are generated as trip data. You can view measurement results and store trip records, by uploading the trip data to the special website “CATEYE Atlas™” via the dedicated software application “CATEYE Sync™”.

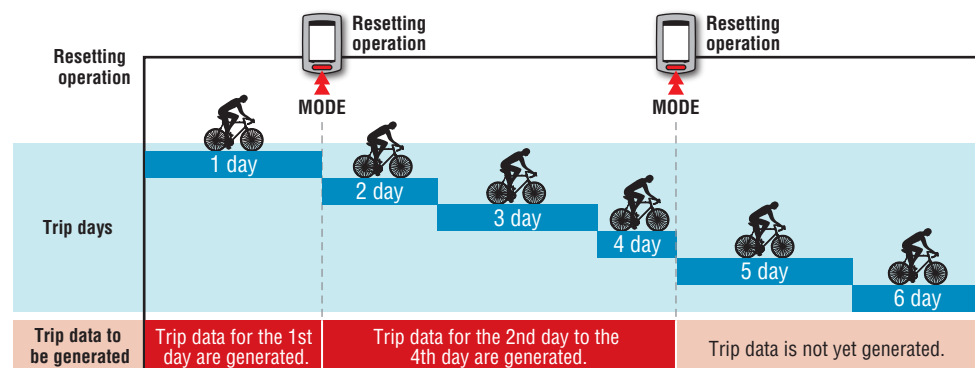
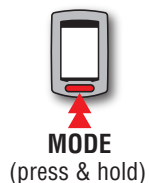

- * A trip is continued unless the resetting operation is performed, even if the power is turned off during measurement.
- * The trip distance-2 (**Dst2**) is not reset to 0, since it is to be reset separately. For details, see “Resetting the trip distance-2” below.
- * The total distance (**Odo**) cannot be reset.
- * For information on how to upload to the CATEYE Atlas™, see “Uploading the measurement data (trip data)” (page 13).
- * The unit has a limited memory capacity. When the data volume exceeds the memory capacity, any new data can no longer be stored. For details, see “Record interval and capacity limit” (page 16).

Resetting the trip distance-2

Pressing and holding the **MODE** button with the trip distance-2 (**Dst2**) displayed resets only the trip distance-2 data to 0.

- * The trip distance-2 (**Dst2**) value cannot be saved as trip data.

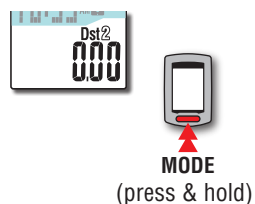

Setup of your PC

At first, access the special website CATEYE Atlas™ to register as a member. Then, install CATEYE Sync™ to your PC (Windows/Mac). You can upload the trip data measured with this unit to CATEYE Atlas™, STRAVA™, TrainingPeaks™ and others, or change the computer configuration using your PC.

⚠ Caution: Use the PC with an Internet access environment to access CATEYE Atlas™ or download CATEYE Sync™.

Membership registration to CATEYE Atlas™

- You can use the same account when using CATEYE INOU and having registered membership.
- When uploading the trip data acquired with this unit only to STRAVA™ or TrainingPeaks™, membership registration of CATEYE Atlas™ is not required. Install CATEYE Sync™, and see “Uploading trip data” (page 13).

1 Access CATEYE Atlas™.

Access the website “CATEYE Atlas™” from your browser (<http://www.cateyeatlas.com>).

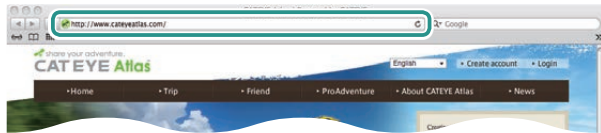

2 Click on [Create account].

Register your temporary membership according to the instructions displayed on the screen. Once you are registered, an e-mail is sent from CATEYE Atlas™. Access to the specified URL to register your formal membership.

- * Membership registration is free of charge.
- * Make a note of your e-mail address, password and birth date registered, and be sure to keep it.



3 Click on [Login here].

4 Enter your e-mail address and password, and then click on [Login].

Enter correctly your e-mail address and password registered to login.

- * Go to “Installing CATEYE Sync™” (on the right of this page).

Installing CATEYE Sync™

Operating environment for CATEYE Sync™

OS	Windows XP (32 bit), and Vista / 7 / 8(32 bit / 64 bit) *.NET Framework 3.5 is required. Mac OS 10.6 or later
Memory	Recommend environment for respective OS
HDD	Available capacity required: 64 MB or more
Browser	Internet Explorer 7 or later, Safari 4.0 or later, Firefox, and Google Chrome 5.0 or later

How to Install CATEYE Sync™

1 Click on [Download CATEYE Sync™ now].

Download the file according to the instructions displayed on the screen.



2 Double click on the execution file downloaded.

OS	Execution file
For Windows	[setup.exe]
For Mac	[CATEYESyncSetUp.pkg]

- * Administrator authority is required to run the program on Windows Vista / 7 / 8.

3 Perform an installation according to the instructions displayed on the screen.

Once installation is completed, CATEYE Sync™ will start.

- * Go to “Setting CATEYE Sync™”(page 12).

Setting CATEYE Sync™

After installing CATEYE Sync™, configure the login setting for CATEYE Atlas™.

* When uploading the trip data only to STRAVA™ or TrainingPeaks™, the following setting is not required.

1 Start CATEYE Sync™.

Double-click on the shortcut [CATEYE Sync™] to start CATEYE Sync™.

2 Click on [Q Series / STEALTH].

The menu screen appears.

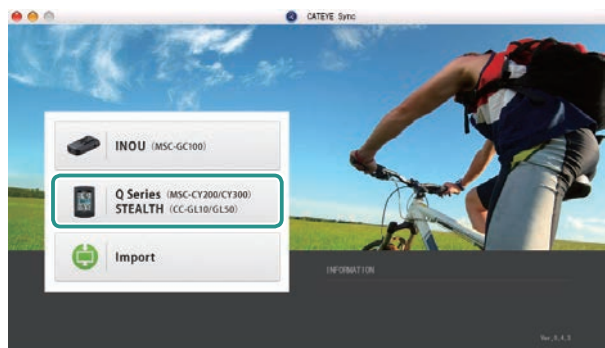

3 Click on [Settings].

The setting screen appears.

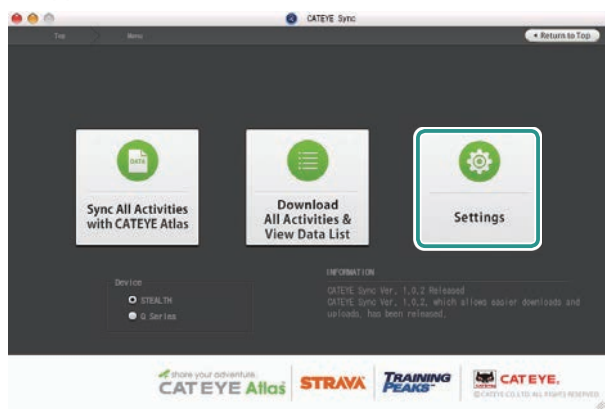

4 Click on [Account setting] and enter your e-mail address and password.

Enter correctly the e-mail address and password you registered at CATEYE Atlas™.

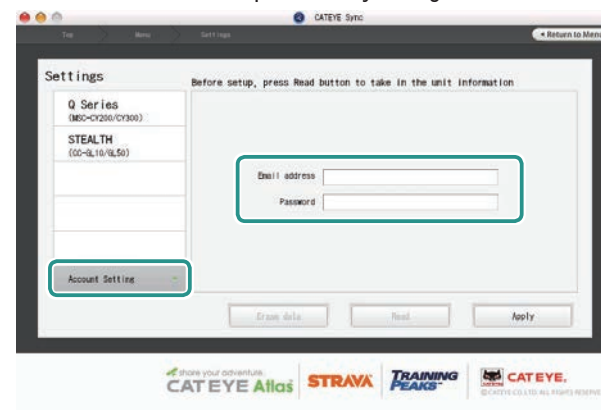

5 Click on [Apply].

Login setting for CATEYE Sync™ is completed.

Now, setup of your PC is completed.

* For information on how to upload the trip data, see “Uploading the measurement data (trip data)” (page 13).

* With CATEYE Sync™, you can synchronize the settings configured in “Setting up the computer” (page 5) with the computer. For details, see “Changing the computer configuration” (page 20).

* When using CATEYE INOU, click on [INOUE] to start INOU Sync. When you use CATEYE INOU for the first time, download CATEYE Sync™ INOU from CATEYE Atlas™ to install it.

Uploading the measurement data (trip data)

The trip data generated by the resetting operation can be uploaded to the special website CATEYE Atlas™ or other services (STRAVA™ and others) in the following procedure.

Uploading trip data

Save the trip data in the computer to your PC, and upload desired trip data to CATEYE Atlas™, STRAVA™, or TrainingPeaks™.

* The trip data without the resetting operation cannot be recognized with CATEYE Sync™. Perform the resetting operation of the computer before setting to the cradle.

Watch video
(YouTube)

Click the button, then a browser will open and a video will be played back.

1 Set the computer to the cradle.

⚠ Caution: Do not set wet computer to the cradle, for example after ride in the rain. It may cause short circuit and damage the computer or the data.

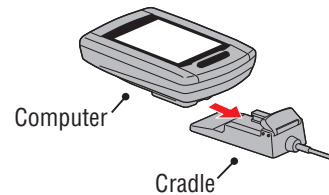

2 Insert the USB plug into your PC.

Only  (battery icon) is displayed on the screen.



3 Start CATEYE Sync™.

Double-click on the shortcut [CATEYE Sync™] to start CATEYE Sync™.

4 Click on [Q Series / STEALTH].

The menu screen appears.

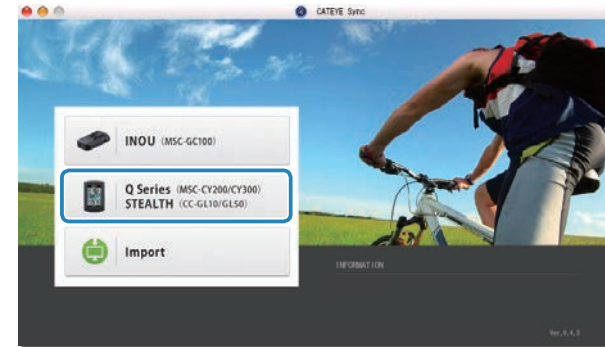

5 Check that “STEALTH” is selected under Device, and click [Download All Activities & View Data List].

The trip data is downloaded from the computer to your PC, and the data list screen appears.

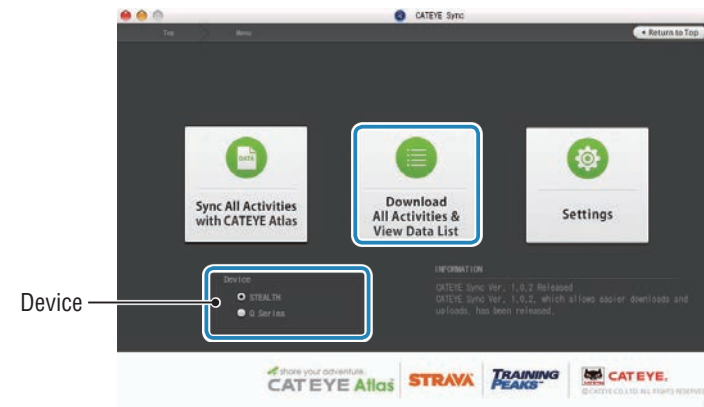

* Trip data successfully downloaded to your PC is deleted from the computer.

* Data under measurement that has not been reset cannot be read.

6 Check that the trip data you want to upload has been selected, and click the desired upload button.

Transferred trip data is displayed in the data list with a check mark.



The loaded trip data includes trips with a distance and time of 0. These trips are data created by the resetting operation before measurement.

* For details, see “Starting/Stopping measurement” (page 9).

Clear the check box for any unnecessary trip data, and then click the upload button for the service site you want to upload the data to.

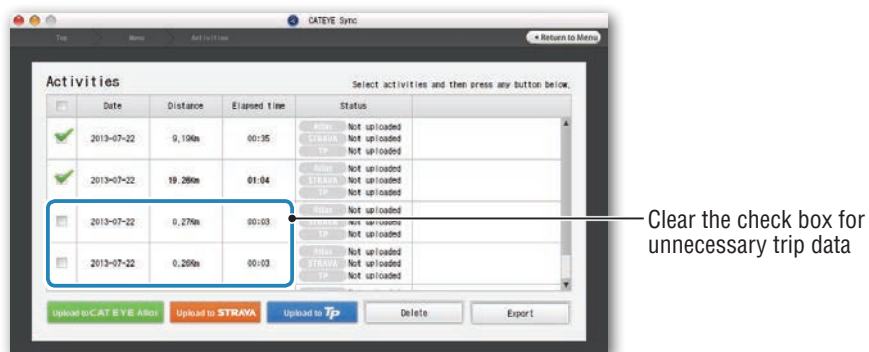

Upload button	Destination of uploaded trip data
	CATEYE Atlas™
	STRAVA™
	TraingPeaks™

* You must have an account with the relevant site to upload data to STRAVA™ or TrainingPeaks™. Site authentication is required when uploading for the first time. After clicking the upload button, follow the on-screen instructions and enter the authentication code issued by the site.

* It may take time to upload depending on the trip data size and line condition.

When the upload is complete, the sites to which the data was uploaded are indicated in the “Status” column and links to the trip are displayed in the adjacent column.



* Clicking the link launches your browser and displays the uploaded trip.

Syncing all activities

Clicking [Sync All Activities] lets you download trip data to your PC and upload trips to service sites with the click of a single button. Trip data is uploaded to the previous service site you used.

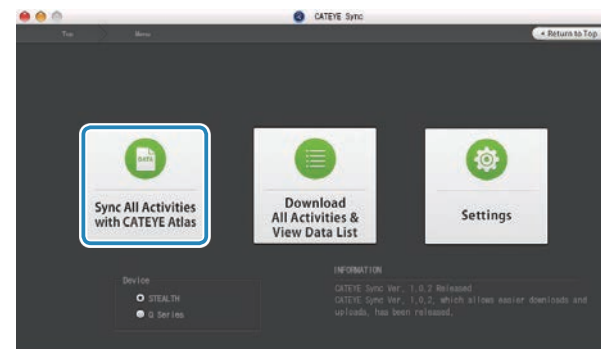

* You can check the upload destination by the color of the button. (Green: CATEYE Atlas™, Orange: STRAVA™, Blue: TrainingPeaks™)

* To upload specific trip data only or upload trip data to a service site other than the last one used, upload using the [Download All Activities & View Data List] button. For details, see Step 6 of “Uploading trip data” (on the left of this page).

Exporting the trip data

You can export the trip data saved in CATEYE Sync™, and create a file.

1 Check any trip data on the data list screen, and then click on [Export].

A dialog for selecting the file format appears.

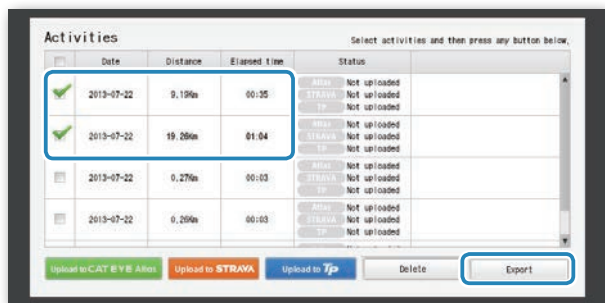

* Selecting data for multiple trips lets you export several files at once.

2 Click on the file format for export.

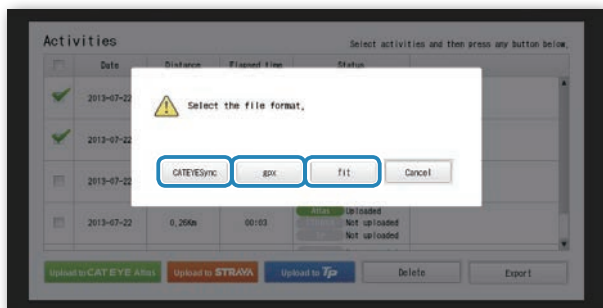

File format	Description
CATEYE Sync (.ces)	A file that can be read into CATEYE Sync™ * This can be used when transferring the trip data in the past to a new PC when renewing your PC.
.gpx	A general-purpose GPS data file * This can be used after reading into Google Earth™, etc.
.fit	A file that can be read into STRAVA™ and TrainingPeaks™

A window for selecting the destination to save appears.

3 Select the destination to save, and then click on [Open].

The file will be exported to the destination specified.

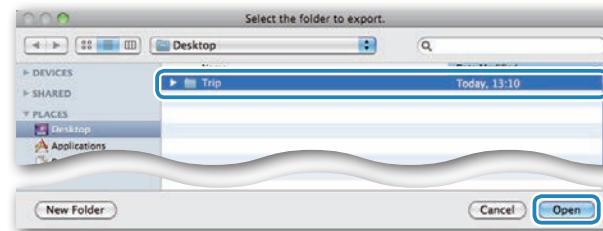

Importing the data of such as e-Train Data™ to CATEYE Sync™

The measurement data loaded into e-Train Data™ can be used with CATEYE Atlas™ and other services (STRAVA™ etc.) by importing it to CATEYE Sync™.

1 Export the measurement data from e-Train Data™, and prepare a file.

* For information on how to export e-Train Data™, see the instruction manual for e-Train Data™.

2 Click on [Import] on the top screen.

A window for selecting the file appears.

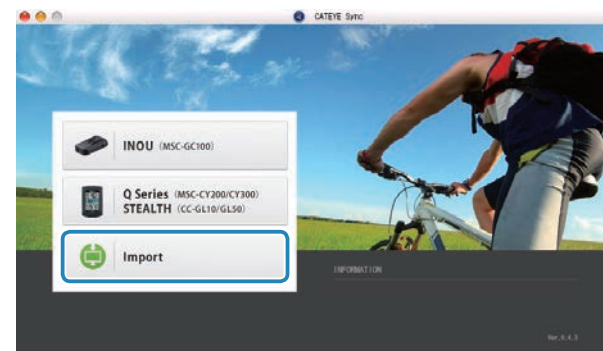

3 Select the file you want to load, and then click on [Open].

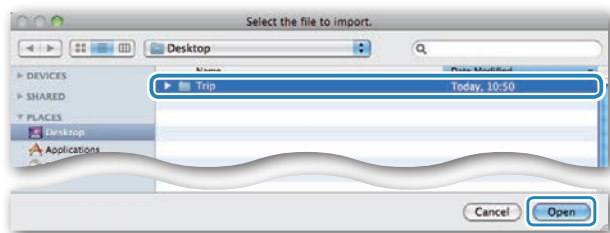

Compatible files	Description
.etd	e-Train Data™ Ver.3/4 file
.csv	e-Train Data™ Ver.2 file
.ces	CATEYE Sync file

* The CATEYE Sync file exported from another PC can also be loaded.

* The CSV files not created with e-Train Data™ Ver.2 cannot be imported. The data list screen appears, and the selected file is added to the data list.

Trip data

Data contained in the trip data

Date and clock (date/time when the measurement started)

Elapsed time

Data recorded at the record interval specified

- Location information
- Trip distance
- Sea level altitude
- Current speed

Record interval and capacity limit

This unit records data at the specified interval. The record interval can be selected from 1, 2 or 5 seconds according to your use (Default: 1 second).

The maximum recording time and the maximum time for one trip depend on the selected record interval as follows.

Record interval	Maximum recording time (total time of all trip data)	Maximum time for one trip	Maximum number of trips
1 second	35 hours	12 hours	250 trips
2 seconds	70 hours	24 hours	
5 seconds	175 hours	60 hours	

* The recording time and number of trips above are for reference only. These may be different according to the operating environment.

* For information on how to set the record interval, see “Changing the computer configuration” (page 20).

* When exceeding any of the conditions above, “**MEM FULL**” appears flashing on the screen, and no new data can be recorded. Transfer the trip data to CATEYE Sync™ to secure the storage volume of the computer. Only when exceeding the maximum time for one trip, the resetting operation (page 10) allows you to start the measurement as another trip.

Reviewing, editing and sharing the trip (What you can do with CATEYE Atlas™)

You can share the trip with your friends and other users, by editing the trip information uploaded to CATEYE Atlas™.

1 Access CATEYE Atlas™.

Access the website “CATEYE Atlas™” from your browser (<http://www.cateyeatlas.com>).

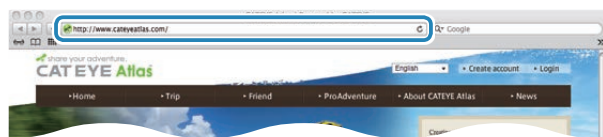

2 Click on [Login here].

* When you have not registered your membership, see “Membership registration to CATEYE Atlas™” (page 11).

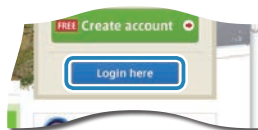

3 Enter your e-mail address and password, and then click on [Login].

Enter correctly your e-mail address and password registered to login. The “My Page” appears.

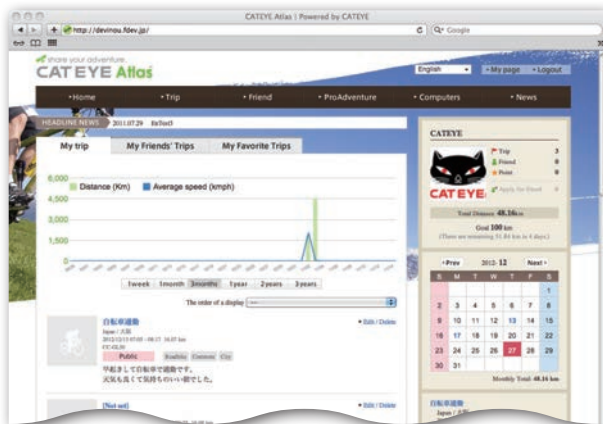

* On My Page, you can view the trip and trip data in the past and set the target trip distance in a certain period of time.

4 Click on the trip uploaded.

A map with the trip route with ride data shown.

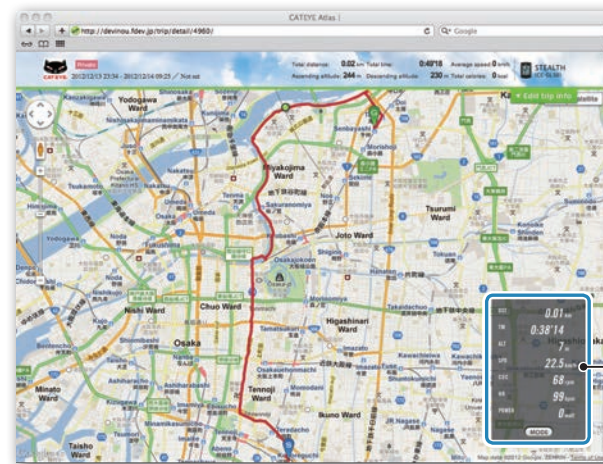

* Clicking on **MODE** under the ride data changes the display items.

5 Click on [Edit trip info] at the upper right of the map.

A screen for editing the trip information appears. Enter information of the trip, including the title, bicycle and memo.

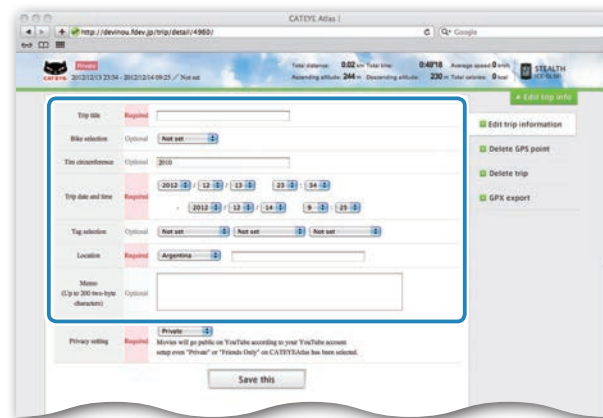

6 Select the privacy setting.

Select the disclosure setting.

- **Private** : Can be viewed only with your account.
- **Public** : All users can view.
- **Friends only** : Only your friends can view.

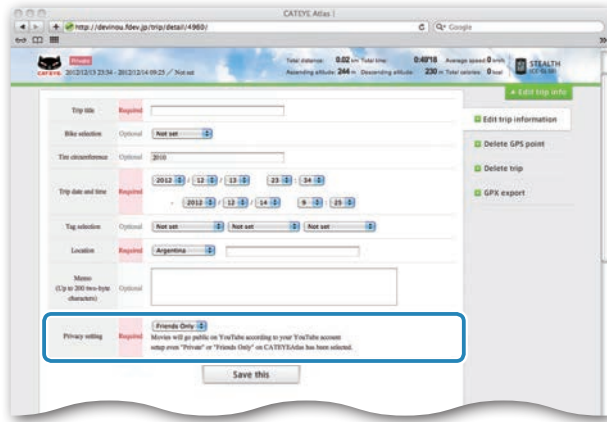

7 Clicking on [Save this].

Now, editing the trip information is completed.

Deleting the GPS point

You can delete particular GPS points on the route.

- 1 Click on [Delete GPS point] from the trip information editing screen.
The trip route appears on the map.

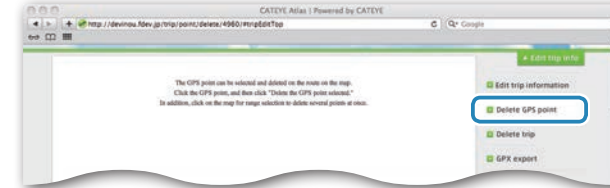

- 2 Click on a start point for the route section you want to delete.
A section appears according to the cursor movement.
- 3 Click on an end point of the section, covering the route you want to delete.
A confirmation message appears.
- 4 Click on [Delete the GPS point selected].
The GPS points in the specified section are deleted.

Deleting the trip

You can delete the trip displayed.

- 1 Click on [Delete trip] on the trip information editing screen.

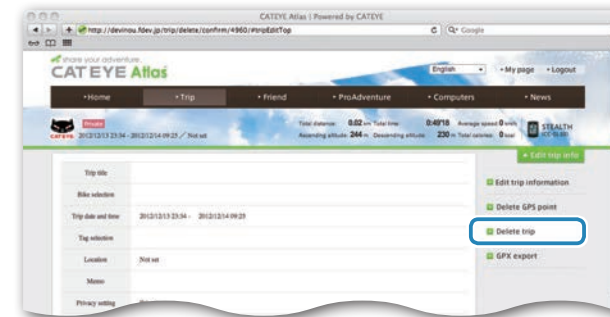

- 2 Click on [Delete].

* The CATEYE Sync™ trip data on your PC is not affected.

* The deleted trip can be restored by re-uploading from CATEYE Sync™.

Exporting to a GPX file

Export a general-purpose GPS data file from the trip.
This can be used with other services, including Google Earth™.

- 1 Click on [GPX export] on the trip information editing screen.
A confirmation message appears.

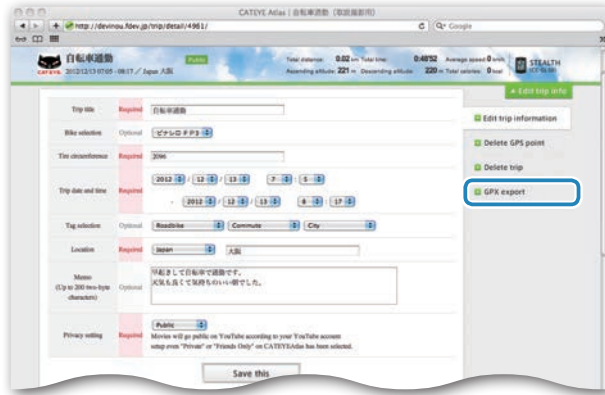

- 2 Click on [Export].
A GPX file is downloaded.

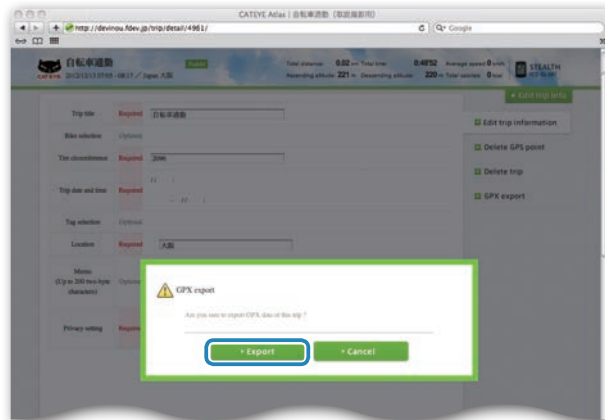

Changing the computer configuration

You can change the computer configuration in two ways.

- Changing the setting with CATEYE Sync™ (below on this page)
You can change the configuration easily from your PC application, with the computer connected to your PC with the cradle.
- Changing the settings of the computer alone (page 22).
This can be used when changing the setting with not using a PC.

Changing the setting with CATEYE Sync™

Watch video
(YouTube)

Click the button, then a browser will open and a video will be played back.

1 Set the computer to the cradle.

⚠ Caution: Do not set wet computer to the cradle, for example after ride in the rain. It may cause short circuit and damage the computer or the data.

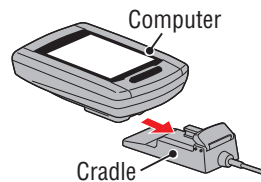

2 Insert the USB plug into your PC.

Only  (battery icon) is displayed on the computer screen.



3 Start CATEYE Sync™.

Double-click on the shortcut [CATEYE Sync™] to start CATEYE Sync™.

4 Click on [Q Series / STEALTH].

The menu screen appears.

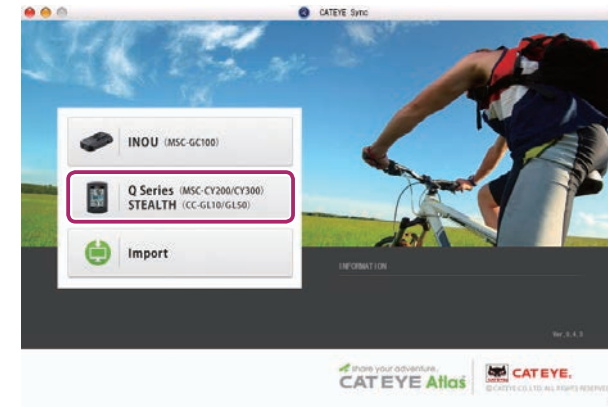

5 Click on [Settings].

The setting screen appears.

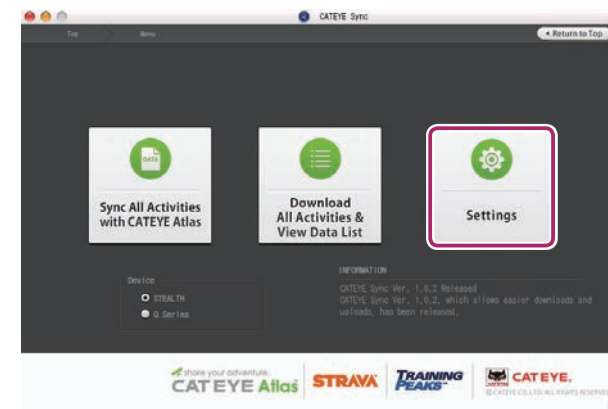

6 Click on [STEALTH] to change the settings.

Before changing the settings, click on [Read] to load the settings of the computer.

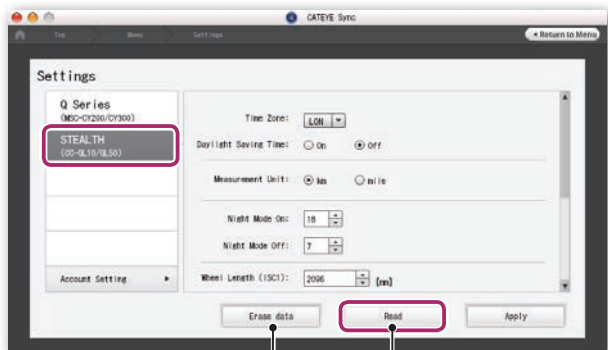

Delete the data recorded in the computer.

Read the current settings of the computer.

Change the settings according to the following procedure.

Setting items	Description
Time zone	Select the city code nearest from your current location. * For details, see "Time zone list" (page 6).
Daylight saving time	Select whether to use the daylight saving time. <ul style="list-style-type: none"> • On : Moves the clock 1 hour ahead. • Off : Displays in regular clock.
Speed unit	Select the speed unit (km/h or m/h).
Night-time setting	Set the time when the backlight lights up. <ul style="list-style-type: none"> • Night-time setting ON : Enter the start time when the backlight lights up. • Night-time setting OFF : Enter the end time when the backlight lights off. (Example) When lighting up from 7:00 pm to 6:00 am Night-time setting ON : 19 Night-time setting OFF : 6 * When you do not want to turn on the backlight throughout the day, set the same value for both "Night-time setting ON" and "Night-time setting OFF".

Setting items	Description
Tire circumference	This is not used with this unit.
Total distance	You can enter the start value of the total distance, and add the trip distance to it. (Setting range : 00000 to 99999) <ul style="list-style-type: none"> * This can be used when you renew and/or reset the computer. * Enter the total distance in integer number only.
Sampling interval	Set the record interval of the measurement data. <ul style="list-style-type: none"> * The maximum recording time (total time of all trip data) and the maximum time for one trip depend on the interval selected. • 1s (at intervals of 1 second) : 35 hours / 12 hours • 2s (at intervals of 2 seconds) : 70 hours / 24 hours • 5s (at intervals of 5 seconds) : 175 hours / 60 hours
Clock display format	Select the display format of "12h" (12 hours display) or "24h" (24 hours display). <ul style="list-style-type: none"> * Date and clock are acquired from GPS signal; therefore, it is not necessary to enter them.

7 Click on [Apply].

The changes are reflected to the computer.

Remove the computer from the cradle. Now, changing the computer configuration is completed.

Changing the settings of the computer alone

Pressing the **MENU** button with the measurement screen displayed changes to the menu screen. Various settings can be changed on the menu screen.

* After you change the setting, be sure to press the **MENU** button to register it.

* Leaving the menu screen without any operation for 1 minute returns to the measurement screen.

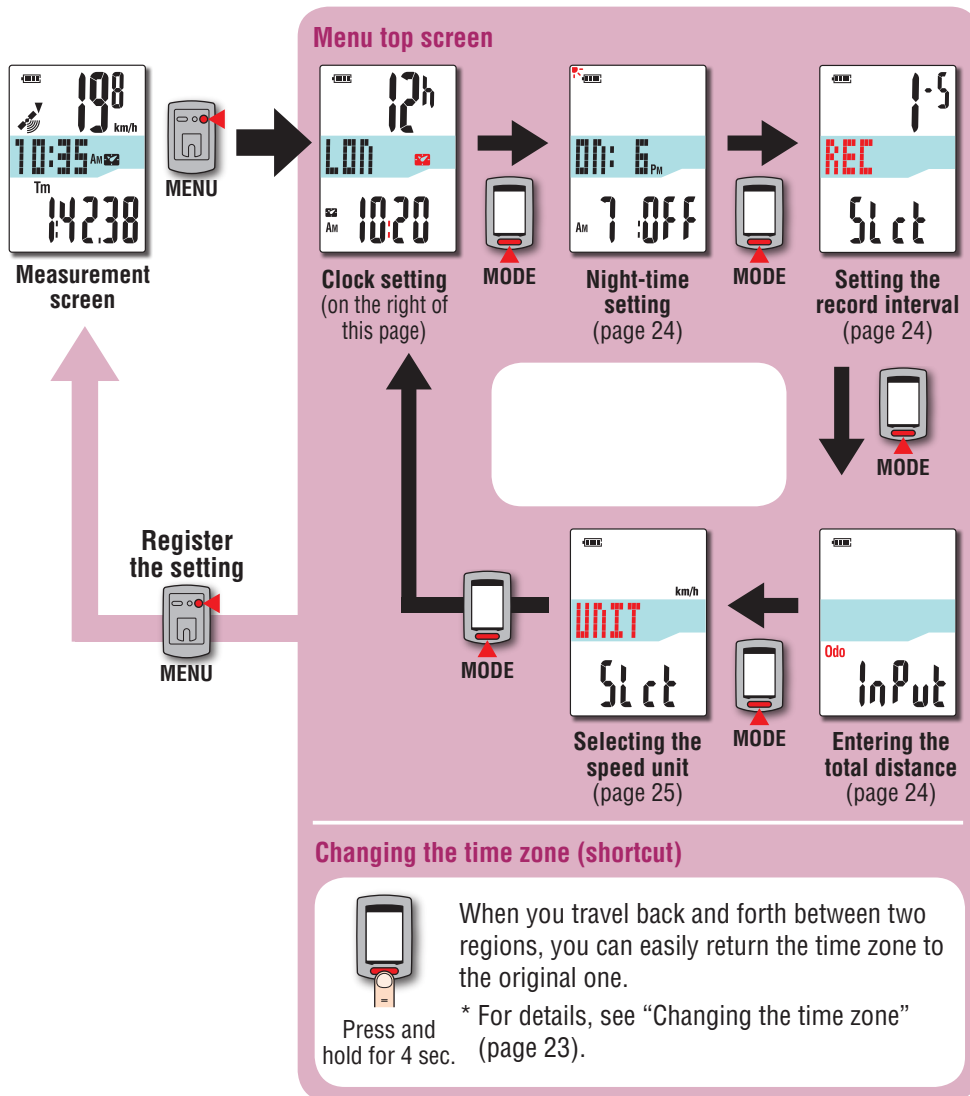

From "Selecting the speed unit" (page 25)

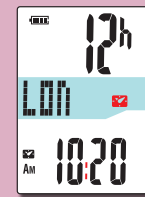

Clock setting

Change the settings of the time zone, daylight saving time, and the clock display format.

* With this unit, it is not necessary to set the clock/date, since they are synchronized after receiving GPS signal.



Changing the settings

MODE
(press & hold)

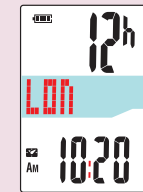

Time zone list

Select the code for the city nearest from your current location.



Switch the display

* For details, see "Time zone list" (page 6).

MODE
(press & hold)

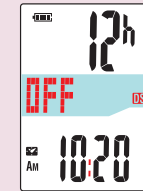

Daylight saving time

Select whether to use the daylight saving time.

ON Moves the clock 1 hour ahead.

OFF Displays in regular clock



ON ↔ OFF

MODE
(press & hold)

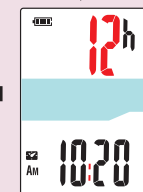

Clock display format

Select the display format of "12h" (12 hours display) or "24h" (24 hours display).



12h ↔ 24h

Register the setting

MENU

To "Night-time setting" (page 24)

* Date and clock are acquired from GPS signal; therefore, it is not necessary to enter them.

Changing the time zone (shortcut)

Holding down the **MODE** button for 4 seconds with the menu top screen displayed returns the time zone to the previous one. Holding down it again returns to the original time zone.

Example: Change the time zone

Current setting	NYC (New York)
Previous setting	TYO (Tokyo)

Every menu top screen

Shortcut



Press and hold for 4 sec.



Register the setting



The time zone is changed from **NYC** (New York) to **TYO** (Tokyo) of the previous setting.

Change the time zone again

Current setting	TYO (Tokyo)
Setting before the change	NYC (New York)

Every menu top screen

Shortcut



Press and hold for 4 sec.

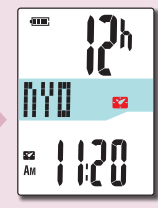

Register the setting



The time zone is changed from **TYO** (Tokyo) to **NYC** (New York) before the change.

* When you travel back and forth between two cities having different time zone, you can easily return it to the original time zone by performing the shortcut operation, even after changing the time zone in the second city.

* The time zone stored for the shortcut is the previous setting only.

Time zone list

City code	City name	Time difference
LON	London	0
PAR	Paris	+1
ATH	Athens	+2
MOW	Moscow	+3
THR	Tehran	+3.5
DXB	Dubai	+4
KBL	Kabul	+4.5
KHI	Karachi	+5
DEL	Delhi	+5.5
DAC	Dhaka	+6
RGN	Yangon	+6.5
BKK	Bangkok	+7
HKG	Hong Kong	+8
TYO	Tokyo	+9

For details, refer to the map on page 6.

City code	City name	Time difference
DRW	Darwin	+9.5
SYD	Sydney	+10
NOU	Noumea	+11
WLG	Wellington	+12
PPG	Pago Pago	-11
HNL	Honolulu	-10
ANC	Anchorage	-9
LAX	Los Angeles	-8
DEN	Denver	-7
CHI	Chicago	-6
NYC	New York	-5
CCS	Caracas	-4
RIO	Rio de Janeiro	-3

From "Clock setting" (page 24)



Night-time setting

Set the time when the backlight lights up.

* When you do not want to turn on the backlight throughout the day, set the start time and end time to the same hour.

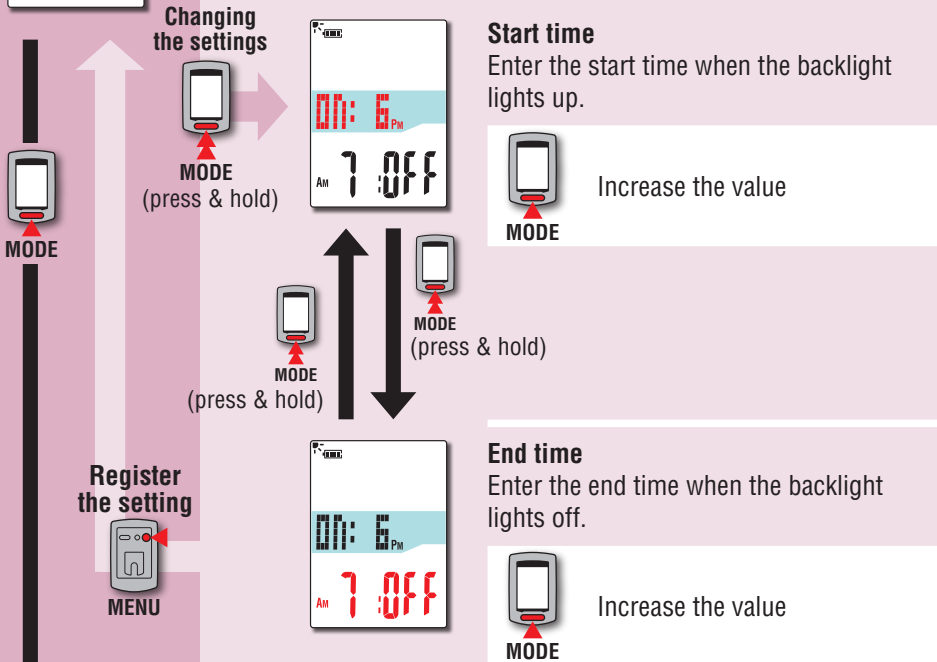

To "Setting the record interval"

From "Night-time setting"



Setting the record interval

Set the second-scale interval to record the measurement data.

* The maximum recording time / maximum time for one trip that can be recorded in the computer depends on the selected interval.

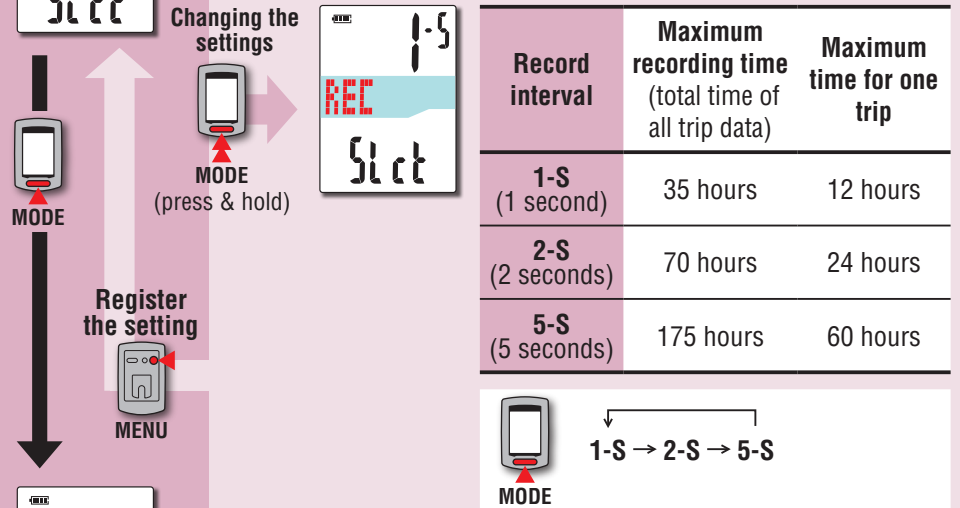

Entering the total distance

You can enter the start value of the total distance, and add the trip distance to it. Use this function when you renew and/or reset your unit.

* Enter the total distance in integer number only.

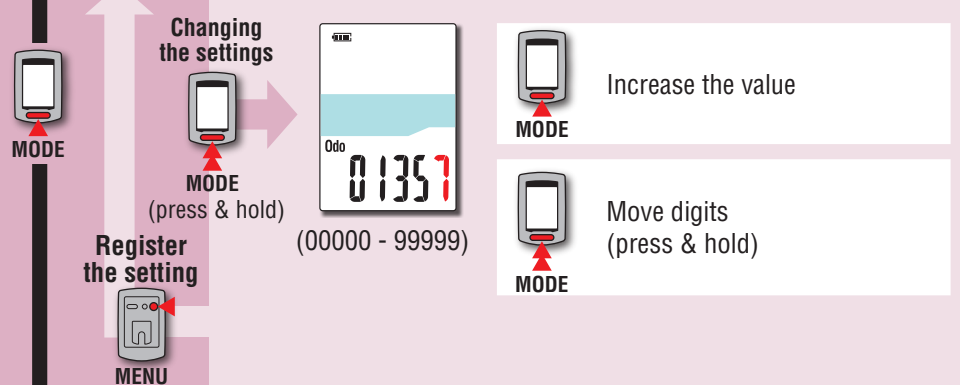

To "Selecting the speed unit" (page 25)

From “Entering the total distance” (page 24)

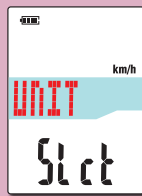

Selecting the speed unit

Select the speed unit (km/h or m/h).

Changing the settings



MODE
(press & hold)

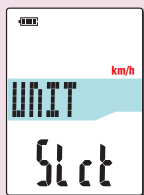

km/h ↔ m/h



MODE

Register the setting



MENU

To “Clock setting” (page 22)

When the operation is unstable

When the computer displays incorrectly, perform the restarting operation to stabilize the operation.

- * Performing the restarting operation deletes any records under measurement.
- * We recommend that you perform the resetting operation to generate the trip data, before performing the restarting operation.

Restarting operation

Press the **AC** button on the back of the computer. All screen items will light up for 2 seconds, and the unit will change to the GPS search screen.

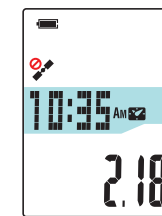
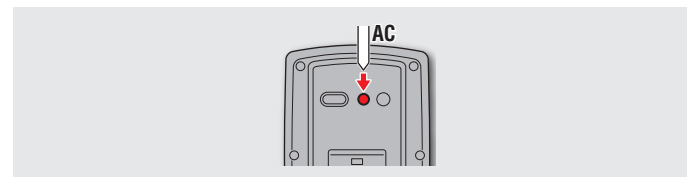

GPS search screen

Data to be stored / data to be deleted

Data to be stored / deleted upon the restarting operation are as follows.



Data to be stored	Data to be deleted
Speed unit	Data under measurement (elapsed time, trip distance, trip distance-2, average speed, maximum speed, and GPS route information)
Clock setting (time zone, previous time zone, daylight saving time, and display format)	
Night-time setting (start time and end time)	
Record interval	
Total distance (*1)	
Trip data generated upon the resetting operation	

*1 Once you perform the restarting operation before the resetting operation after measurement, the distance is not added to the total distance.

Troubleshooting

The following troubles are not due to failure.

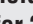
See also “FAQ” in CATEYE Atlas™ (web) (<http://www.cateyeatlas.com/qa/>).

Trouble	Check Items	Remedy
When the power is turned on,  (battery icon) flashes, and then no display appears.	–	Remaining battery capacity is nearly zero. Charge the computer according to the procedure in “How to charge” (page 5).
The power is turned off while riding.	–	The power is turned off automatically in 10 minutes without GPS signal received. (Auto power off)
No display appears by pressing and holding the  button for 2 seconds.	Is the battery for the computer empty?	Charge the computer according to the procedure in “How to charge” (page 5).
Incorrect data appear.	–	Follow the procedure in “When the operation is unstable” (page 25).
Measurement cannot be performed  flashes on the display).	Is it immediately after turning on the power?	It may take about 2 to 3 minutes to acquire the positional information after receiving GPS signal.
	Is it out of the GPS service area?	GPS signal does not reach, thus cannot be received in a tunnel and underground, between high-rise buildings, under an elevated structure, etc.
	Is the weather not suitable for receiving GPS signal?	GPS signal may not be received when it is raining or snowing.
	Is the unit installed so that the computer display (antenna) faces to the sky?	To receive GPS signal effectively, install the unit so that the computer display faces to the sky.

Trouble	Check Items	Remedy
The measurement data is wrong.	–	Measurement may stop, or the measurements may differ from the actual value depending on the GPS receiving status, since this unit measures using GPS signal.
MEM FULL flashes.	Does the maximum recording time or the number of trips exceed the upper limit? * For details, see “Record interval and capacity limit” (page 16)	Connect the computer to your PC to upload the trip data (page 13). All the trip data transferred to your PC will be deleted from the computer, and new data will be able to be recorded.
	Does the maximum time for one trip exceed the upper limit? * For details, see “Record interval and capacity limit” (page 16)	Perform the resetting operation (page 10) to stop the current trip. Then, you can record as another trip.
The backlight does not light up even at the preset hour.	Are the start time and end time set to the same hour?	The backlight does not light up when the start time and end time are set to the same hour. For information on how to set the start/end time, see “Changing the computer configuration” (page 20).
The backlight lights up during the daytime.	Is the start time of the night-time set correctly?	For information on how to set the start time, see “Changing the computer configuration” (page 20).

Maintenance

To clean the computer or accessories, use diluted neutral detergent on a soft cloth, and wipe it off with a dry cloth.

How to dispose the computer

Remove the screws (x 6) on the back of the computer using a Phillips screwdriver, remove the rechargeable battery built-in, and then dispose the computer.

⚠ Caution:

- The used battery should be disposed of properly according to local regulations.
- Do not disassemble the unit except when you dispose it.
- Be sure to use up the rechargeable batteries.
- Keep the removed batteries out of baby's reach.
If a child swallows a battery, consult a doctor immediately.

Optional accessories

1600280N
Bracket band

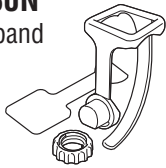

1602193
Bracket

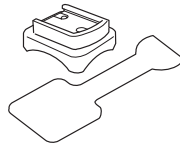

1603790
Cradle
(IF-CC01)

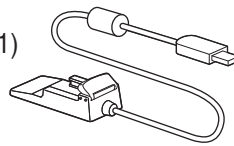

Specification

Measurement function	Upper display	Current speed	0.0 (3.0) - 105.9 km/h [0.0 (2.0) - 65.9 m/h]
	Middle display	Clock	0:00 - 23:59 [AM1:00 - PM12:59] (Both 12 and 24-hour modes can be selected) (Automatic adjustment using GPS)
	Lower display	Elapsed Time	0:00'00" - 9:59'59"
		Trip Distance	0.00 - 999.99 km [mile]
		Trip Distance-2	0.00 - 999.99 / 1000.0 - 9999.9 km [mile]
		Average Speed	0.0 - 105.9 km/h [0.0 - 65.9 m/h]
		Maximum Speed	0.0 (3.0) - 105.9 km/h [0.0 (2.0) - 65.9 m/h]
Total Distance	0.0 - 9999.9 / 10000 - 99999 km [mile]		
Date	1.1 - 12.31 (Automatic adjustment using GPS)		
Battery	Lithium-ion rechargeable battery		
Charge and communication	USB cradle		
Standard charging time	Approx. 5 hours (USB2.0)		
Standard operating time	Approx. 10 hours		
Recharge/discharge number of times	About 300 times (until the rated capacity drops to 70%)		
Controller	Microcomputer (crystal controlled oscillator)		
Display	Liquid crystal display (EL backlight: Lights up always during the night-time)		
Working temperature	0 °F - 104 °F (0 °C - 40 °C) (This product will not display appropriately when exceeding the Working Temperature range. Slow response or black LCD at lower or higher temperature may happen respectively.)		
Dimensions/weight	2-23/32" x 1-49/64" x 7/8" (69 x 45 x 22.4 mm) / 1.76 oz (50 g)		

* The specifications and design are subject to change without notice.

Limited warranty

2-year Warranty: Computer only

(Deterioration of the battery is excluded.)

CatEye cycle computers are warranted to be free of defects from materials and workmanship for a period of two years from original purchase. If the product fails to work due to normal use, CatEye will repair or replace the defect at no charge. Service must be performed by CatEye or an authorized retailer. To return the product, pack it carefully and enclose the warranty certificate (proof of purchase) with instruction for repair. Please write or type your name and address clearly on the warranty certificate. Insurance, handling and transportation charges to CatEye shall be borne by person desiring service.

For UK and REPUBLIC OF IRELAND consumers, please return to the place of purchase. This does not affect your statutory rights.

Please register your CatEye product on the website.
<https://www.cateye.com/en/support/regist/>

CAT EYE CO., LTD.

2-8-25, Kuwazu, Higashi Sumiyoshi-ku, Osaka 546-0041 Japan

Attn: CATEYE Customer Service Section

Phone : (06)6719-6863

Fax : (06)6719-6033

E-mail : support@cateye.co.jp

URL : <http://www.cateye.com>

[For US Customers]

CATEYE AMERICA, INC.

2825 Wilderness Place Suite 1200, Boulder CO 80301-5494 USA

Phone : 303.443.4595

Toll Free : 800.5.CATEYE

Fax : 303.473.0006

E-mail : service@cateye.com