



U.S. Pat. Nos. 4642606/5904442/Pat. and Design Pat. Pending
Copyright © Aug. 2000 CAT EYE Co., Ltd.
OS1SME-001019 [066600061] 2

Important

The position of the sensor and the magnet should be as shown:

Side view

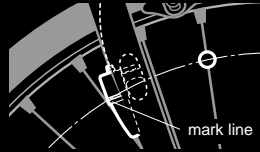

mark line

Top view

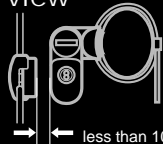

less than 10 mm

Align the center of the magnet (F) and the sensor's mark line while rotating the wheel or crank.

The clearance between the sensor (C) and the magnet (F) should be less than 10 mm.

Mounting View

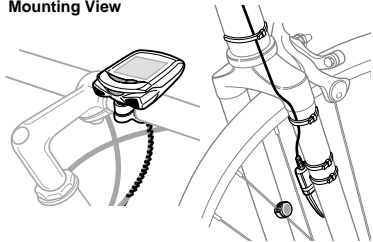

1 Magnet

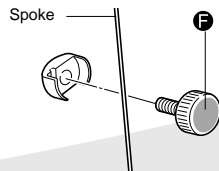

Parts of Names

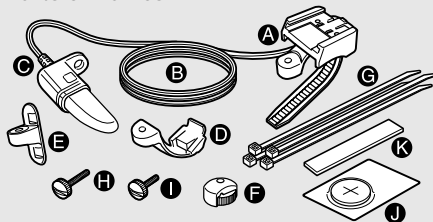

- A Bracket
- B Wire
- C Speed sensor
- D Bracket band
- E Sensor spacer
- F Magnet
- G Nylon tie
- H Bracket screw (long)
- I Sensor screw (short)
- J Lithium battery (CR2032)
- K Bracket rubber pad

2 Speed Sensor

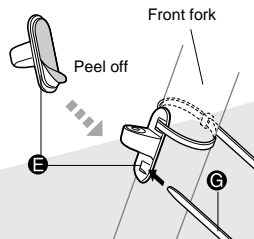

Front fork

Peel off

3 Wire

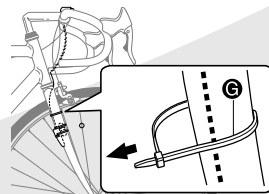

Fasten the screws securely

4 Bracket

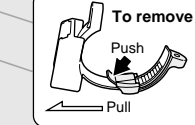
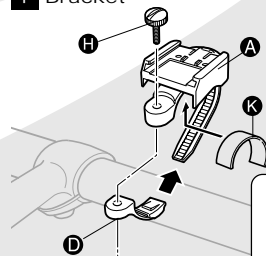

To remove

Push

Pull

Caution!

Insure enough wire clearance in the area marked with ← to allow the handlebar to fully rotate without pulling the wire.

5 Main Unit

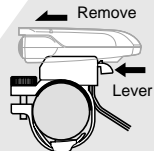
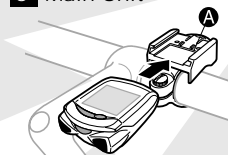

Remove

Lever

Mount

Names

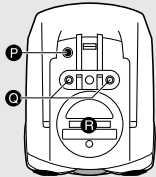
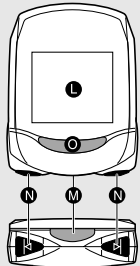

- L Liquid crystal display
- M START/STOP button [ENTER button]
- N MODE button [SELECT button (FWD/REV)]
- O MENU button
- P RESTART button
- Q Contacts
- R Battery cover

2 Format operation

Format your unit before starting various setting. Hold down both MODE/SELECT buttons simultaneously, press and release RESTART button. Select "YES" and press ENTER/START/STOP.

1 Installing battery

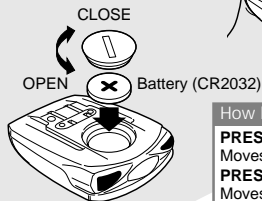

How buttons work in the SETUP process:

PRESSING FWD BUTTON:

Moves to the right or increases the figure

PRESSING REV BUTTON:

Moves to the left or decreases the figure

PRESSING BOTH FWD/REV BUTTONS:

Goes back to the previous screen

PRESSING ENTER BUTTON:

Enters the figure and executes the selection

Setup

• Custom Setup

Select your favorite functions and preferred font size. (See "Reference guide" page 7.)

3 Speed scale setting



4 Tire size setting



EASY ----- 14inch~27inch
CUSTOM --- 10~9999mm

5 Date setting



6 Time scale setting

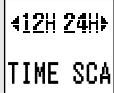

7 Clock time setting



8 Custom setup entrance
Select "NO".

Setup finished

How to Use

• Tire Size Calibration Chart

TIRE SIZE	mm	inch	TIRE SIZE	mm	inch	TIRE SIZE	mm	inch	TIRE SIZE	mm	inch	TIRE SIZE	mm	inch
CUSTOM	EASY		CUSTOM	EASY		CUSTOM	EASY		CUSTOM	EASY		CUSTOM	EASY	
12 x 1.75	935		24 x 1	1753		26 x 1-1/8	1970		26 x 3.00	2170		700 x 23C	2096	
14 x 1.50	1020		24 x 3/4Tu	1785		26 x 1-3/8	2068		27 x 1	2145		700 x 25C	2105	
14 x 1.75	1055	14inch	24 x 1-1/8	1795		26 x 1-1/2	2100	26/650	27 x 1-1/8	2155	27/700	700 x 28C	2136	
16 x 1.50	1185		24 x 1-1/4	1905		26 x 1.40	2005		27 x 1-1/4	2161		700 x 30C	2170	
16 x 1.75	1195	16inch	24 x 1.75	1890	24inch	26 x 1.50	2010		27 x 1-3/8	2169		700 x 32C	2155	
18 x 1.50	1340		24 x 2.00	1925		26 x 1.75	2023		650 x 35A	2090		700CTubu	2130	
18 x 1.75	1350	18inch	24 x 2.125	1965		26 x 1.95	2050		650 x 38A	2125		700 x 35C	2168	
20 x 1.75	1515		26 x 7/8	1920		26 x 2.00	2055		650 x 38B	2105		700 x 38C	2180	
20 x 1-3/8	1615	20inch	26 x 1(59)	1913		26 x 2.10	2068		700 x 18C	2070		700 x 40C	2200	
22 x 1-3/8	1770	22inch	26 x 1(65)	1952		26 x 2.125	2070		700 x 19C	2080				
22 x 1-1/2	1785		26 x 1.25	1953		26 x 2.35	2083		700 x 20C	2086				

• Start/stop of measurement

By a press of START/STOP button, the unit starts measuring; by another press, it stops measuring. While measuring, the speed scale icon flashes.

START/STOP/ENTER button measures Elapsed Time (Tm), Trip Distance (Dst) and Average Speed (Av).

Maximum Speed (Mx) and Total Distance (Odo) continue to be measured regardless of start/stop.

• Changing lower display

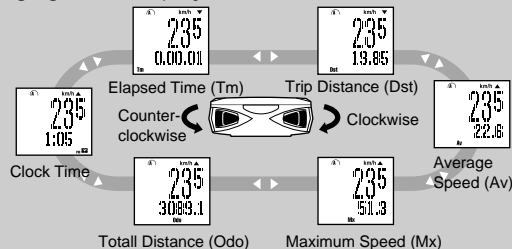

• Reset operation

Press START/STOP/ENTER button and either of MODE/SELECT button simultaneously, and the data other than Total distance (Odo) and Clock Time is reset.

Press simultaneously