

**Read me first.**



U.S. Pat. Nos. 4642606/5904442/Pat. and Design Pat. Pending  
 Copyright© 2001 CAT EYE Co., Ltd.  
 OS.1.1SE-011025 066600151

**Important**

The position of the sensor and the magnet should be as shown:

**Side view**

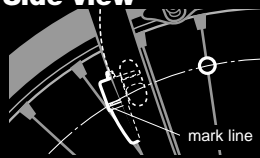

Align the center of the magnet **F** and the sensor's mark line while rotating the wheel or crank.

**Top view**

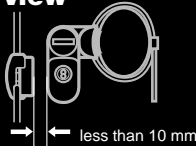

The clearance between the sensor **C** and the magnet **F** should be less than 10 mm.

**Mounting View**

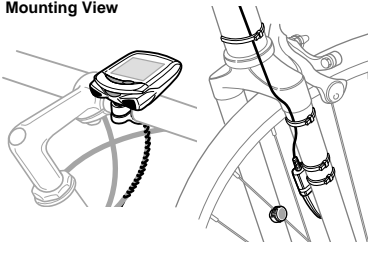

**1 Magnet**

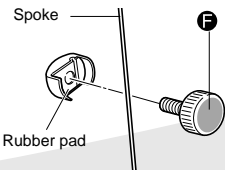

**2 Speed Sensor**

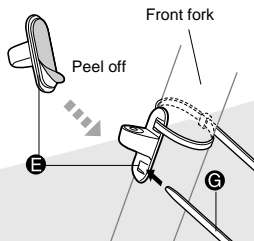

**Part Names**

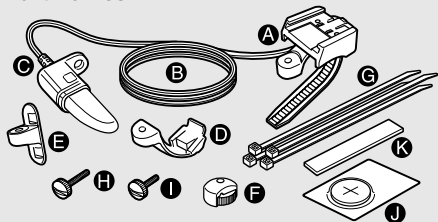

- A** Bracket
- B** Wire
- C** Speed sensor
- D** Bracket band
- E** Sensor spacer
- F** Magnet
- G** Nylon tie
- H** Bracket screw (long)
- I** Sensor screw (short)
- J** Lithium battery (CR2032)
- K** Bracket rubber pad

**Fasten the screws securely**

**3 Wire**

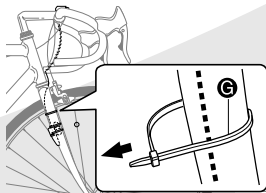

**4 Bracket**

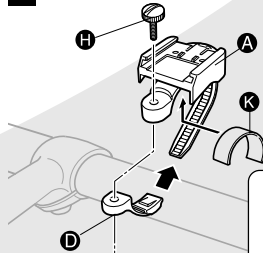

**5 Main Unit**

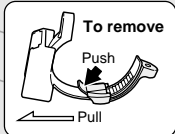
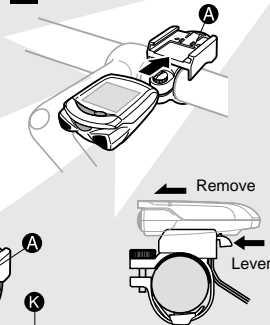

**Caution!:**  
 Insure enough wire clearance in the area marked with ← to allow the handlebar to fully rotate without pulling the wire.

**Mount**

## • Names

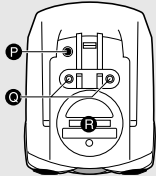
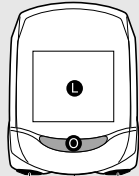

- L Liquid crystal display
- M START/STOP button [ENTER button]
- N MODE button [SELECT button (FWD/REV)]
- O MENU button
- P RESTART button
- Q Contacts
- R Battery cover

## 2 Format operation

Format your unit before starting various setting. Hold the unit as shown in the figure below. PRESS AND HOLD the two MODE/SELECT buttons, press and release RESTART button on the back of the OS. CONTINUE HOLDING DOWN the two MODE/SELECT buttons for TWO MORE SECONDS and let go. Now the FORMAT YES/NO prompt will appear. Select YES and press ENTER/START/STOP button.

## 1 Installing battery

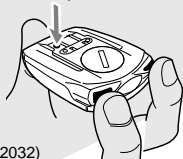

CLOSE  
OPEN  
Battery (CR2032)

FORMAT?  
← YES NO →

### How buttons work in the SETUP process:

START/STOP button (ENTER)



REV FWD  
MODE button (SELECT)

**PRESSING FWD BUTTON:**  
Moves to the right or increases the figure

**PRESSING REV BUTTON:**  
Moves to the left or decreases the figure

**PRESSING BOTH FWD/REV BUTTONS:**  
Goes back to the previous screen

**PRESSING ENTER BUTTON:**  
Enters the figure and executes the selection

# Setup

## • Custom Setup

Select your favorite functions and preferred font size. (See "Reference guide" page 5.)

### 4 Tire size setting

← CUSTOM →  
EASY →  
TIRE SIZ

EASY ----- 14inch~27inch  
CUSTOM --- 100~3999mm  
(See "Tire Size Calibration Chart" page 16.)

### 3 Speed scale setting

← mile/h →  
km/h →  
SPEED SC

### 5 Date setting

2001  
YEAR

### 6 Time scale setting

← 12H 24H →  
CLOCK TI

### 7 Clock time setting

00:00  
CLOCK TI

### 8 Custom setup entrance

Select "NO".

Setup finished

## • Start/stop of measurement

By a press of START/STOP button, the unit starts measuring; by another press, it stops measuring. While measuring, the speed scale icon flashes. START/STOP/ENTER button measures Elapsed Time (Tm), Trip Distance (Dst) and Average Speed (Av). Maximum Speed (Mx) and Total Distance (Odo) continue to be measured regardless of start/stop.



## • Changing lower display

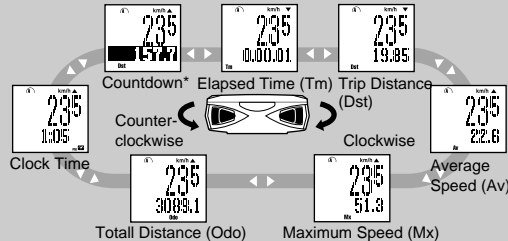

# How to Use

## • Icons on the screen

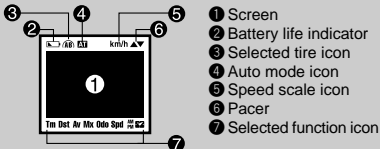

## • Reset operation

Press START/STOP/ENTER button and either of MODE/SELECT button simultaneously, and the data other than Total distance (Odo) and Clock Time is reset.

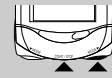

Press simultaneously